

Z:\1700001-1700990\1700990\8839 Midvale Ave\CAD\Design\OnSite\WM-CO.00-CV.dwg

Ad6f6fT

Jan 07, 2019 - 3:19pm

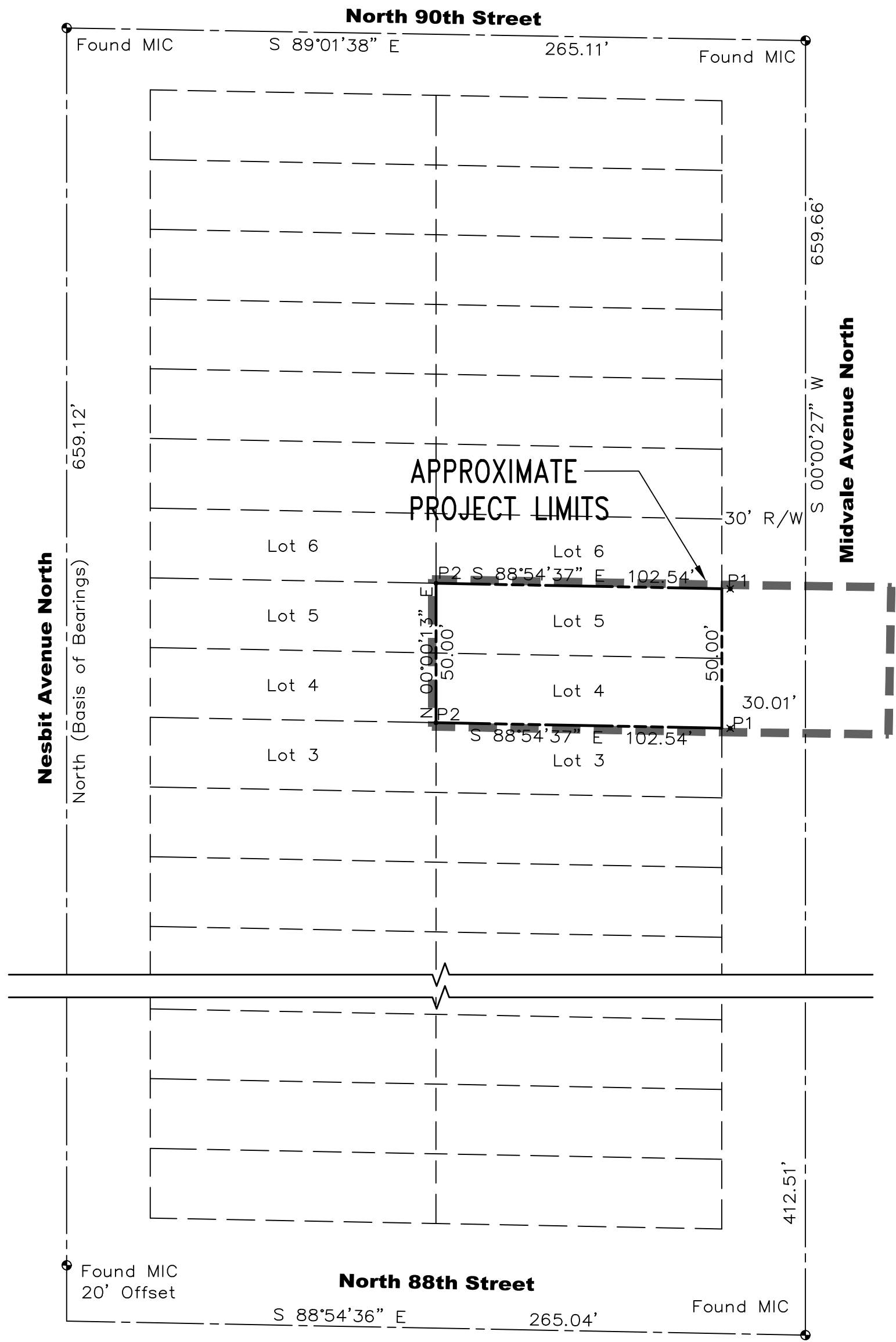

SURVEY SITE NOTES, EXISTING LEGEND, AND LOCAL CONTROL DIAGRAM INFORMATION ARE SHOWN HEREON FOR REFERENCE ONLY. REFER TO SURVEY PREPARED BY EMERALD LAND SURVEYING, INC., DATED 09/25/2017 FOR ALL SURVEY INFORMATION.

SURVEYOR'S NOTES:

SURVEY PERFORMED BY:
EMERALD LAND SURVEYING, INC.
PO BOX 13694 MILL CREEK, WA 98082
PH. (425) 359-7198

LEGAL DESCRIPTION:
LOTS 4 AND 5, BLOCK 7, BOULEVARD PLACE ADDITION TO THE CITY OF SEATTLE, ACCORDING TO THE PLAT THEREOF, RECORDED IN VOLUME 5 OF PLATS, PAGE 2, RECORDS OF KING COUNTY, WASHINGTON.

APN 099300-0380

PROPERTY CORNERS:
P1 SET TACK IN LEAD W/ TAG, LS 30581, 3' OFFSET P2 SET REBAR & CAP, LS 30581

INSTRUMENT USED: SOKKIA SET 5 EDM
METHOD USED: FIELD TRAVERSE

APPROXIMATE POINT ACCURACY: ±0.05'

SURVEY MEETS OR EXCEEDS STATE STANDARDS PER WAC 332-130-090.

MONUMENTS SHOWN HEREON WERE VISITED ON SEPTEMBER 18, 2017.

THE INFORMATION SHOWN ON THIS MAP REPRESENTS THE RESULTS OF A SURVEY MADE ON THE INDICATED DATE AND CAN ONLY BE CONSIDERED AS THE GENERAL EXISTING CONDITION AT THAT TIME.

NO EASEMENTS, RESTRICTIONS OR RESERVATION OF RECORD WHICH WOULD BE DISCLOSED BY A TITLE REPORT ARE SHOWN.

VERTICAL DATUM:
NAVD 88
CONTOUR INTERVAL - 2 FEET

BENCH MARK:
POINT NAME: SNV-7535 "CITY OF SEATTLE BRASS CAP, STAMPED 7535, 10' S OF THE INT OF BKCW, 0.33' W OF BKCW, OPP. FIRE HYDRANT AT THE SE QUAD OF THE INT OF AURORA AVENUE N & N 88TH ST" ELEV: 271.975.

EXISTING LEGEND:

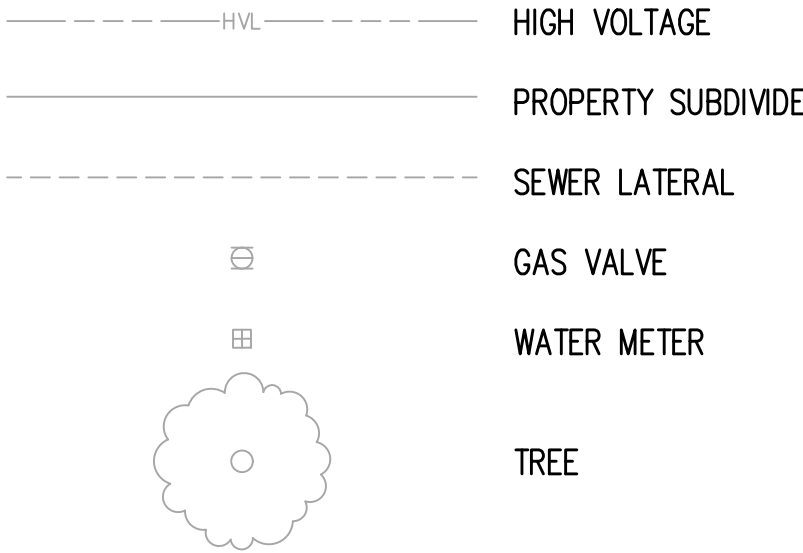

ABBREVIATIONS:

BRP	BIORETENTION PLANTER (NON-INFILTRATING)
COS	CITY OF SEATTLE
DI	DUCTILE IRON
IE	INVERT ELEVATION
ELV	ELEVATION
EX	EXISTING
FFE	FINISH FLOOR ELEVATION
GPM	GALLONS PER MINUTE
LF	LINEAL FEET
MIN	MINIMUM
POC	POINT OF CONNECTION
PVC	POLYVINYL CHLORIDE
SD	STORM DRAIN
SDCI	SEATTLE DEPARTMENT OF CONSTRUCTION AND INSPECTIONS
SF	SQUARE FEET
SPU	SEATTLE PUBLIC UTILITIES
STD	STANDARD
SSS	SIDE SEWER SANITARY
TC	TOP OF CURB
TYP	TYPICAL

CIVIL LEGEND:

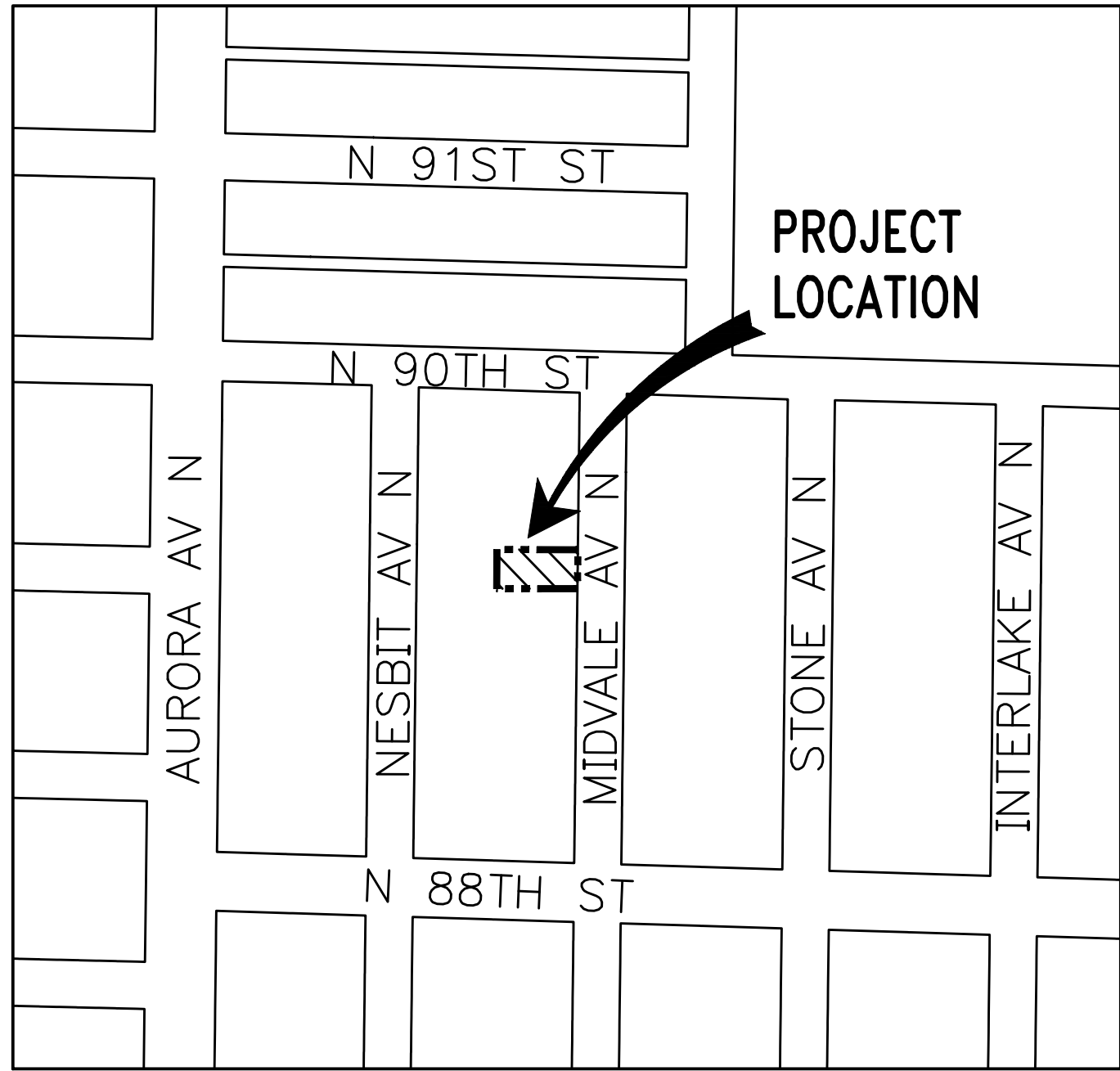
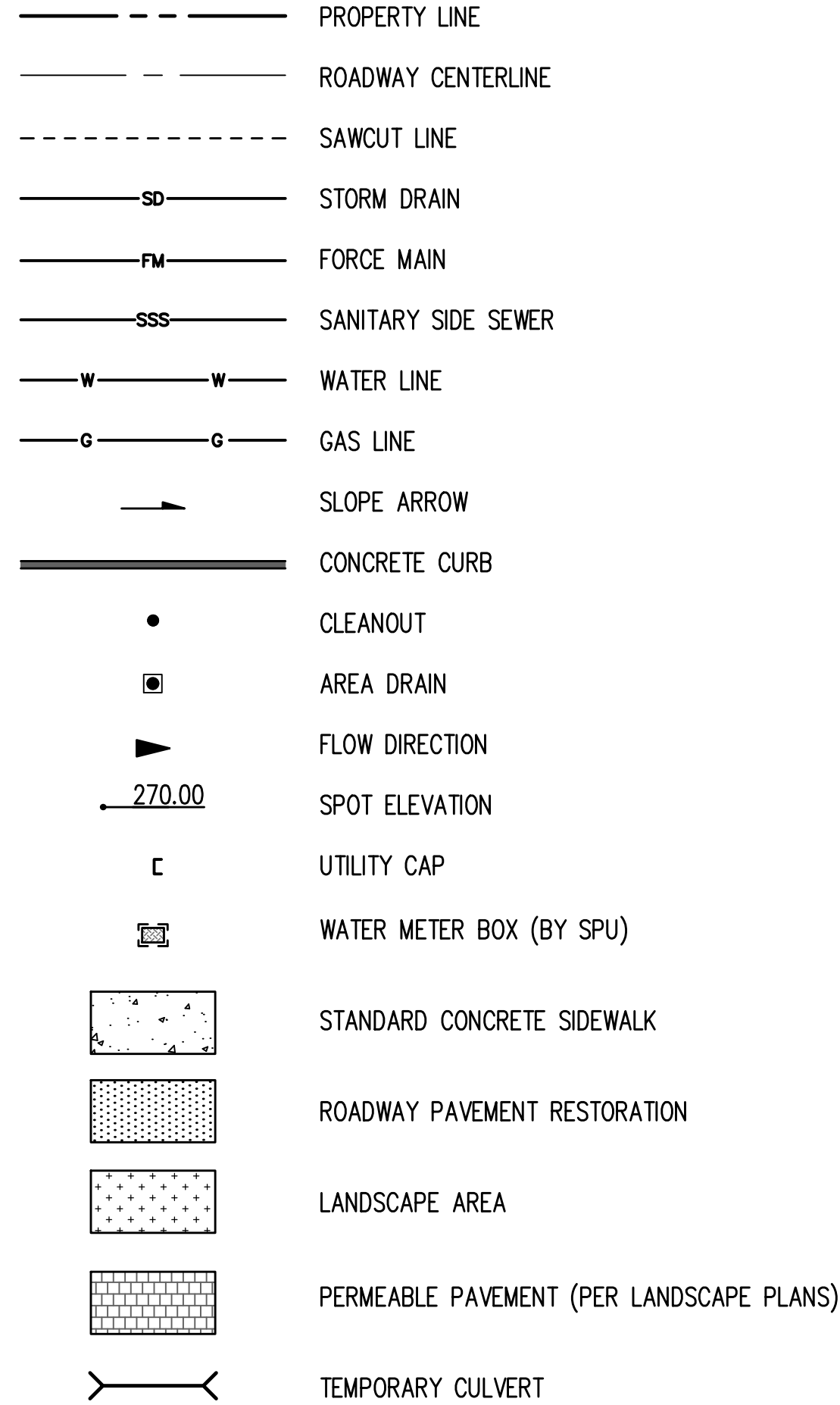

CONTRACTOR IS ALERTED TO THE FACT THAT WORK WILL BE ACCOMPLISHED AROUND ACTIVE PSE GAS AND ENERGIZED SEATTLE CITY LIGHT (SCL) FACILITIES THAT ARE SERVING EXISTING CUSTOMERS. CONTRACTOR SHALL COORDINATE WITH PSE AND SCL TO DETERMINE WHICH FACILITIES ARE ACTIVE AND ENERGIZED AND SHALL IMPLEMENT SAFETY PROCEDURES PER PSE AND SCL REQUIREMENTS. CONTRACTOR SHALL COORDINATE WITH PSE AND SCL TO ENSURE THAT FACILITIES ARE IN PLACE TO MAINTAIN SERVICE TO CUSTOMERS THROUGHOUT CONSTRUCTION.

CIVIL SHEET INDEX	
SHT NO.	SHEET TITLE
C0.00	COVER SHEET
C0.01	GENERAL NOTES
C1.00	TESC PLAN
C1.01	TESC DETAILS
C2.00	SITE PAVING & HORIZONTAL CONTROL
C2.01	PAVING DETAILS
C3.00	GRADING & STORM DRAINAGE PLAN
C3.01	STORM DRAIN DETAILS
C4.00	UTILITY PLAN
C5.00	ON-SITE STORMWATER MANAGEMENT PLAN

CARON
2505 3RD AVE #300C
SEATTLE WA 98121
T 206.367.1382 F 206.367.1385
W CARONARCHITECTURE.COM

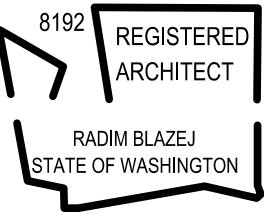

kpff
1601 5th Avenue, Suite 1600
Seattle, WA 98101
206.622.5822
www.kpff.com
MIDVALE TOWNHOUSES

8839 MIDVALE AVE N
SEATTLE, WA 98103

SDCI # 6628930-CN
BUILDING PERMIT SUBMITTAL

DISCLAIMER
THIS SET OF DRAWINGS AND DOCUMENTS IS FOR BUILDING PERMIT SUBMITTAL ONLY AND DOES NOT CONSTITUTE A COMPLETE SET OF DOCUMENTS FOR ANY OTHER PURPOSE.

SUBMITTAL / REVISION	DATE
BUILDING PERMIT SUBMITTAL	05.17.2018
BUILDING PERMIT RE-SUBMITTAL	01.07.2019



SHEET TITLE
COVER SHEET

SHEET NUMBER
C0.00

CARON PROJECT NO. 17_085

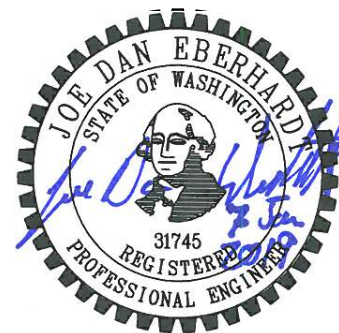

2: \\720001-1700990\1700990_8839 Midvale Ave\CAD\Design\05Sta\W1-C0.0-C1.dwg
Ade66T
Jan 07, 2019 - 3:19pm

GENERAL NOTES:

1. ALL WORK SHALL CONFORM TO THE 2017 EDITION OF CITY OF SEATTLE STANDARD SPECIFICATIONS, THE 2017 EDITION OF THE CITY OF SEATTLE STANDARD PLANS; AND SEATTLE DEPARTMENT OF TRANSPORTATION DIRECTOR'S RULE 01-2017: RIGHT-OF-WAY OPENING AND RESTORATION RULES (ROWORR). A COPY OF THESE DOCUMENTS SHALL BE ON SITE DURING CONSTRUCTION.

2. A COPY OF THE APPROVED PLAN MUST BE ON SITE WHENEVER CONSTRUCTION IS IN PROGRESS.

3. ERRORS AND OMISSIONS ON THE PERMITTED PLANS MUST BE CORRECTED BY THE ENGINEER AND APPROVED BY THE CITY OF SEATTLE.

4. ALL PERMITS REQUIRED FOR WORK WITHIN THE PUBLIC RIGHT OF WAY MUST BE OBTAINED PRIOR TO THE START OF CONSTRUCTION.

5. PRIOR TO THE START OF CONSTRUCTION WITHIN THE RIGHT OF WAY, THE PERMITTEE SHALL SCHEDULE AND ATTEND A PRECONSTRUCTION MEETING WITH THE CITY OF SEATTLE DEPARTMENT OF TRANSPORTATION.

6. PERMITTEE SHALL CONTACT SEATTLE DEPARTMENT OF TRANSPORTATION, STREET USE INSPECTOR A MINIMUM OF 2 BUSINESS DAYS PRIOR TO NEEDING AN INSPECTION.

7. ALL DAMAGE TO CITY INFRASTRUCTURE CAUSED BY THE CONSTRUCTION SHALL BE IMMEDIATELY REPORTED AND REPAIRED AS REQUIRED BY THE SEATTLE DEPARTMENT OF TRANSPORTATION. TO REPORT DAMAGE TO SPU INFRASTRUCTURE, INCLUDING ANY SEWAGE RELEASE OR BLOCKAGE, CALL 206-386-1800.

8. THE APPROVED PLANS SHALL SHOW THE APPROXIMATE AREA OF PAVEMENT RESTORATION BASED ON THE DEPTH OF UTILITY CUTS AND/OR THE AREA OF CURB AND/OR PAVEMENT TO BE REMOVED AND REPLACED. THE ACTUAL LIMITS OF THE PAVEMENT RESTORATION SHALL BE PER THE STREET AND SIDEWALK PAVEMENT OPENING AND RESTORATION DIRECTOR'S RULE 05-2009 AND WILL BE DETERMINED IN THE FIELD BY THE SEATTLE DEPARTMENT OF TRANSPORTATION STREET USE INSPECTOR PRIOR TO THE PAVEMENT RESTORATION. FOR SPU WATER SERVICES, APPLICANT MUST SHOW THE PAVEMENT RESTORATION LIMITS FOR THE PROPOSED AND THE EXISTING WATER SERVICES TO BE RETIRED, INCLUDING SERVICES THAT ARE OUTSIDE THE PROJECT AREA, BUT SERVE THE PARCEL.

9. DATUM: NAVD 88 AND NAD83 (1991).

10. SURVEYING AND STAKING OF ALL IMPROVEMENTS IN THE PUBLIC RIGHT OF WAY SHALL BE COMPLETED PRIOR TO CONSTRUCTION. PERMITTEE TO STAKE THE CURB AT THE CENTERLINE OF DRAINAGE GRATES PER STANDARD PLAN 260A. SURVEY CUT SHEETS MUST BE SUBMITTED AND APPROVED BY THE SEATTLE DEPARTMENT OF TRANSPORTATION AT LEAST 5 BUSINESS DAYS PRIOR TO CONSTRUCTION.

11. IF AN EXISTING CURB IS TO BE REMOVED AND REPLACED IN THE SAME LOCATION THE PERMITTEE SHALL PROVIDE THE STREET USE INSPECTOR A PLAN WITH EXISTING FLOW LINE AND TOP OF CURB ELEVATIONS IDENTIFIED. PERMITTEE TO STAKE THE LOCATION OF THE EXISTING CURB PRIOR TO DEMOLITION.

12. THE PERMITTEE SHALL BE RESPONSIBLE FOR REFERENCING AND REPLACING ALL MONUMENTS THAT MAY BE DISTURBED, DESTROYED OR REMOVED BY THE PROJECT AND SHALL FILE AN APPLICATION FOR PERMIT TO REMOVE OR DESTROY A SURVEY MONUMENT WITH THE WASHINGTON STATE DEPARTMENT OF NATURAL RESOURCES, PURSUANT TO RCW 58.24.040(8).

13. THE PERMITTEE SHALL SUBMIT ALL APPLICABLE DOCUMENTS REQUIRED UNDER SECTION 1-05.3 OF THE STANDARD SPECIFICATIONS PRIOR TO CONSTRUCTION. A MATERIAL SOURCE FORM FOR ALL MATERIALS TO BE PLACED IN THE RIGHT OF WAY AND MIX DESIGNS FOR ALL ASPHALT, CONCRETE AND AGGREGATES TO BE PLACED IN THE RIGHT OF WAY MUST BE SUBMITTED TO THE SEATTLE DEPARTMENT OF TRANSPORTATION FOR REVIEW AND APPROVAL PRIOR TO BEGINNING CONSTRUCTION. A REVISED MATERIAL SOURCE FORM AND MIX DESIGNS MUST BE SUBMITTED FOR REVIEW AND APPROVAL PRIOR TO PLACEMENT OF ANY SUBSTITUTE MATERIALS.

14. THE PERMITTEE SHALL NOTIFY THE SEATTLE FIRE DEPARTMENT DISPATCHER (206-386-1495) AT LEAST TWENTY-FOUR (24) HOURS IN ADVANCE OF ALL WATER SERVICE INTERRUPTIONS, HYDRANT SHUTOFFS, AND STREET CLOSURES OR OTHER ACCESS BLOCKAGE. THE PERMITTEE SHALL ALSO NOTIFY THE DISPATCHER OF ALL NEW, RELOCATED, OR ELIMINATED HYDRANTS RESULTING FROM THIS WORK.

15. THE PERMITTEE SHALL LOCATE AND PROTECT ALL CASTINGS AND UTILITIES DURING CONSTRUCTION.

16. THE PERMITTEE SHALL CONTACT THE UNDERGROUND UTILITIES LOCATOR SERVICE (1-800-424-5555) AT LEAST 48 HOURS PRIOR TO CONSTRUCTION.

17. IT IS THE SOLE RESPONSIBILITY OF THE PERMITTEE TO VERIFY THE ACCURACY OF ALL UTILITY LOCATIONS SHOWN AND TO FURTHER DISCOVER

AND AVOID ANY OTHER UTILITIES NOT SHOWN WHICH MAY BE AFFECTED BY THE IMPLEMENTATION OF THIS PLAN.

18. THE PERMITTEE SHALL ADJUST ALL EXISTING MANHOLE RIMS, DRAINAGE STRUCTURE LIDS, VALVE BOXES, AND UTILITY ACCESS STRUCTURES TO FINISH GRADE WITHIN AREAS AFFECTED BY THE PROPOSED IMPROVEMENTS.

19. THE PERMITTEE SHALL FOLLOW SPU CORE TAP PROCEDURES FOR ALL NEW CONNECTIONS TO EXISTING SEWER OR DRAINAGE MAINS OR STRUCTURES. CONTRACTORS ARE NOT ALLOWED TO CORE INTO MAINS OR STRUCTURES WITHOUT PRIOR APPROVAL FROM SPU-DWW. TO SCHEDULE CORE CUTS CONTACT SPU-DWW AT 206-615-0511 A MINIMUM OF 2 BUSINESS DAYS IN ADVANCE.

20. UTILITY SERVICE CONNECTIONS SHOWN ON THIS PLAN REQUIRE SEPARATE PERMITS.

21. THE PERMITTEE SHALL PROVIDE FOR ALL TESTING AS REQUIRED BY THE STREET USE INSPECTOR.

22. INSPECTION AND ACCEPTANCE OF ALL WORK IN THE PUBLIC RIGHT-OF-WAY SHALL BE DONE BY REPRESENTATIVES OF THE CITY OF SEATTLE. IT SHALL BE THE PERMITTEE'S RESPONSIBILITY TO COORDINATE AND SCHEDULE APPROPRIATE INSPECTIONS ALLOWING FOR PROPER ADVANCE NOTICE. THE SEATTLE DEPARTMENT OF TRANSPORTATION STREET USE INSPECTOR MAY REQUIRE REMOVAL AND RECONSTRUCTION OF ANY ITEMS PLACED IN THE RIGHT OF WAY THAT DO NOT MEET CITY STANDARDS OR THAT WERE CONSTRUCTED WITHOUT APPROPRIATE INSPECTIONS.

23. THE PERMITTEE SHALL PROVIDE A PLAN FOR STORMWATER AND EROSION CONTROL AND INSTALL, MAINTAIN AND REMOVE TEMPORARY FACILITIES PER SECTION 8-01. AS CONSTRUCTION PROGRESSES AND CONDITIONS DICTATE, ADDITIONAL CONTROL FACILITIES MAY BE REQUIRED. DURING THE COURSE OF CONSTRUCTION IT SHALL BE THE OBLIGATION AND RESPONSIBILITY OF THE PERMITTEE TO ADDRESS ANY NEW CONDITIONS THAT MAY BE CREATED BY THE PERMITTEE'S ACTIVITIES AND TO PROVIDE ADDITIONAL FACILITIES THAT MAY BE NEEDED TO PROTECT ADJACENT PROPERTIES.

24. ALL DISTURBED SOILS MUST BE AMENDED PER STANDARD PLAN 142 AND SECTION 8-02 OF THE STANDARD SPECIFICATIONS UNLESS WITHIN ONE FOOT OF A CURB OR SIDEWALK, THREE FEET OF A UTILITY STRUCTURE (E.G. WATER METER, UTILITY POLE, HAND HOLE, ETC.), OR THE DRIPLINE OF AN EXISTING TREE.

25. ALL TRAFFIC CONTROL SHALL BE IN ACCORDANCE WITH THE CITY OF SEATTLE TRAFFIC CONTROL MANUAL FOR IN-STREET WORK. AN APPROVED TRAFFIC CONTROL PLAN WILL BE REQUIRED FOR ALL ARTERIAL STREETS PRIOR TO BEGINNING CONSTRUCTION.

26. ANY CONSTRUCTION OR INSTALLATION ACTIVITIES AFFECTING TRANSIT OPERATIONS OR FACILITIES MUST BE COORDINATED THROUGH METRO TRANSIT CONSTRUCTION INFORMATION CENTER. FOR NOTIFICATION INFORMATION AND GUIDELINES, PLEASE VISIT: <http://www.kingcounty.gov/transportation/kcdot/MetroTransit/Construction.aspx> OR CONTACT CONSTRUCTION COORDINATORS AT 206-447-1140. PLEASE PROVIDE FIVE BUSINESS DAYS NOTIFICATION FOR BUS REROUTES AND THREE BUSINESS DAYS NOTIFICATION FOR BUS STOP IMPACTS.

27. COORDINATE SIGN AND PAY STATION AND/OR PARKING METER HEAD REMOVAL AND INSTALLATION WITH SEATTLE DEPARTMENT OF TRANSPORTATION AT 684-5370. SIGNPOSTS ARE TO BE INSTALLED IN ACCORDANCE WITH STANDARD PLANS 616, 620, 621A, 621B, 625, & 626.

28. ALL STREET NAME SIGNS MUST BE INSTALLED BY SEATTLE DEPARTMENT OF TRANSPORTATION AT THE PERMITTEE'S EXPENSE.

29. ALL WORK PERFORMED BY SEATTLE CITY LIGHT, SEATTLE PUBLIC UTILITIES, AND OTHER UTILITIES TO REPAIR, REMOVE OR RELOCATE EXISTING UTILITIES SHALL BE DONE AT THE PERMITTEE'S EXPENSE.

30. PERMITTEE MUST CONTACT THE SEATTLE DEPARTMENT OF PARKS AND RECREATION TO APPLY FOR A SEPARATE PERMIT IF WORKING WITHIN A DESIGNATED PARK BOULEVARD.

31. CARE SHALL BE EXERCISED WHEN EXCAVATING OR REMOVING PAVEMENT NEAR EXISTING CHARGED WATER MAINS. CAST IRON WATER MAINS ARE KNOWN TO BE SENSITIVE TO EXCESSIVE VIBRATION. COORDINATE PROTECTION METHODS WITH SPU.

32. PERMITTEE SHALL CONTACT SEATTLE DEPARTMENT OF TRANSPORTATION, STREET USE INSPECTOR A MINIMUM OF 2 BUSINESS DAYS PRIOR TO PLANTING FOR INSPECTION OF STREET TREES AND LANDSCAPING.

WATER SERVICE NOTES:

1. APPLICATION FOR A NEW METERED WATER SERVICE AND PAYMENT OF ALL FEES IS REQUIRED BEFORE SERVICE WILL BE AVAILABLE.
2. APPLICANT WILL NEED A WATER AVAILABILITY CERTIFICATE (WAC) AND LEGAL DESCRIPTION OF PROPERTY WHEN SUBMITTING THE APPLICATION. TO OBTAIN A WAC, PLEASE CONTACT THE DEVELOPMENT SERVICES OFFICE AT (206) 684-3333 OR SPUWATERAVAILABILITY@SEATTLE.GOV.
3. ALL WATER SERVICES SHALL BE LOCATED IN THE PUBLIC RIGHT OF WAY AND WITHIN THE FRONTAGE OF THE PARCEL BEING SERVED.
4. WATER SERVICES SERVING PARCELS WITHOUT FRONTAGE TO THE PUBLIC RIGHT OF WAY (SUCH AS UNIT LOT SUBDIVISIONS) OR LANDLOCKED PARCELS SHALL BE SERVED BY A PRIVATE WATER SERVICE EXTENDING FROM THE WATER METER TO THE PARCEL BEING SERVED. THE WATER SERVICE SHALL BE INSTALLED IN A DEDICATED EASEMENT. THE EASEMENT SHALL BE OBTAINED BY THE DEVELOPER, RECORDED, AND A COPY SHALL BE PROVIDED TO SEATTLE PUBLIC UTILITIES (SPU) AT THE TIME OF APPLICATION SUBMITTAL.
5. ALL WATER SERVICES PIPING ON PROPERTY MUST BE INSPECTED PRIOR TO BACKFILLING TRENCH. CONTACT (206) 684-5800 TO REQUEST AN INSPECTION.
6. CUSTOMERS ARE REQUIRED TO INSTALL AN APPROVED AIR GAP OR REDUCED-PRESSURE BACKFLOW ASSEMBLY (RPBA/RPDA) ON ALL WATER SERVICE CONNECTIONS POSING A HIGH HEALTH CROSS-CONNECTION HAZARD (PURSUANT TO WAC 246-290-490). BACKFLOW PREVENTION IS ALSO REQUIRED ON WATER SERVICE CONNECTIONS SUCH AS FIRE SERVICES, IRRIGATION SERVICES, BUILDINGS EXCEEDING THREE STORIES OR 30 FT. IN HEIGHT ABOVE THE METER (MEASURED TO THE HIGHEST WATER FIXTURE), AND MAY BE REQUIRED FOR OTHER WATER SERVICES. SPU AND KING COUNTY HEALTH DEPARTMENT (KCHD) ARE THE ADMINISTRATIVE AUTHORITIES ENGAGED IN A JOINT PROGRAM IDENTIFYING ACTUAL AND POTENTIAL CROSS-CONNECTIONS BETWEEN THE PUBLIC WATER SUPPLY AND POSSIBLE SOURCES OF CONTAMINATION. FOR ANSWERS TO SPECIFIC CROSS-CONNECTION CONTROL QUESTIONS OR TO REQUEST AN INSPECTION, PLEASE CALL (206) 684-3536.

SIDE SEWER NOTES:

UNLESS OTHERWISE NOTED

1. ALL WORK MUST CONFORM TO THE SEATTLE DEPARTMENT OF CONSTRUCTION AND INSPECTIONS (SDCI) DIRECTOR'S RULE 4-2011, REQUIREMENTS FOR DESIGN AND CONSTRUCTION OF SIDE SEWERS.
2. THE PERMITTEE MUST MAINTAIN DRAINAGE AND SEWER SERVICE TO PRIVATE PROPERTY DURING CONSTRUCTION.
3. RELAY OR REPAIR OF SERVICE DRAINS/SIDE SEWERS NOT SHOWN FOR CONSTRUCTION ON THE APPROVED PLAN MUST BE UNDER SEPARATE PERMIT FROM SDCI.
4. WHEN SHOWN ON THE APPROVED PLAN, RELAY EXISTING SERVICE DRAINS/SIDE SEWERS TO CLEAR OVER OR UNDER THE NEW UTILITY AND RECONNECT WITH SHIELDED FLEXIBLE REPAIR COUPLINGS PER SPECIFICATIONS 7-17.3(2)E AND 9-05.18 AND AS APPROVED BY A REPRESENTATIVE OF THE CITY OF SEATTLE.
5. SERVICE DRAIN/SIDE SEWER PIPE MUST BE OF A MATERIAL APPROVED BY A REPRESENTATIVE OF THE CITY OF SEATTLE, FROM THE FOLLOWING, IN ORDER OF PRECEDENCE:

A) DIP WHEN MINIMUM CLEARANCES REQUIRED IN SPECIFICATION 1-07.17(2) ARE NOT MET. DIP MUST BE CEMENT MORTAR LINED DUCTILE IRON PIPE PER SPECIFICATION 9-05.3. JOINTS MUST BE RUBBER GASKET, PUSH-ON OR MECHANICAL. BEDDING MUST BE CLASS D PER SPECIFICATION 7-17.3(1)D.

B) MATCH EXISTING PIPE MATERIAL. BEDDING MUST BE CLASS B PER SPECIFICATION 7-17.3(1) FOR EACH PIPE MATERIAL.

C) PVC PIPE AND FITTINGS MUST BE PER ASTM D 3034, SDR35 (MIN), WITH RUBBER GASKET JOINTS OR SCHEDULE 40 PER ASTM D1785 WITH SOLVENT WELDED JOINTS. BEDDING MUST BE CLASS B PER SPECIFICATION 7-17.3(1)B.
6. SERVICE DRAINS/SIDE SEWERS MUST NOT BE BACKFILLED UNTIL THE PIPE HAS BEEN INSPECTED AND APPROVED AND THE SLOPE, LOCATION AND DEPTH IS RECORDED.
7. THE PERMITTEE IS RESPONSIBLE FOR AS-BUILT RECORD INFORMATION FOR ALL WORK ON SERVICE DRAINS/SIDE SEWERS.

CONSTRUCTION STORMWATER CONTROL (CSC)

GENERAL NOTES:

1. A FIRST GROUND DISTURBANCE INSPECTION IS REQUIRED PRIOR TO START OF WORK ON ALL SITES WITH LAND DISTURBING ACTIVITY.
2. SCHEDULE A FIRST GROUND DISTURBANCE INSPECTION FOR AN ISSUED BUILDING PERMIT AT 206-684-8900 OR ONLINE AT WWW.SEATTLE.GOV/DPD/PERMITS/INSPECTIONS/
3. THE APPLICANT SHALL DESIGNATE AN EROSION AND SEDIMENT CONTROL (ESC) SUPERVISOR WHO SHALL BE RESPONSIBLE FOR THE INSTALLATION AND MAINTENANCE OF EROSION AND SEDIMENT CONTROL BEST MANAGEMENT PRACTICES (BMPS). FOR LARGE CONSTRUCTION PROJECTS, THE ESC SUPERVISOR SHOULD BE A CERTIFIED EROSION AND SEDIMENT CONTROL LEAD (CESCL). PROVIDE THE NAME AND PHONE NUMBER OF THE ESC SUPERVISOR TO THE SITE INSPECTOR AT THE FIRST GROUND DISTURBANCE INSPECTION.
4. BMPS SHALL BE INSTALLED PRIOR TO STARTING CONSTRUCTION TO ENSURE SEDIMENT-LADEN WATER DOES NOT LEAVE THE PROJECT SITE OR ENTER ROADSIDE DITCHES, STORM DRAINS, SURFACE WATERS, OR WETLANDS.
5. THE BMPS INCLUDED IN THIS PLAN ARE THE MINIMUM REQUIREMENTS FOR ANTICIPATED SITE CONDITIONS. THE APPLICANT IS RESPONSIBLE FOR ENSURING THAT BMPS ARE MODIFIED AS NEEDED FOR UNEXPECTED STORM EVENTS OR OTHER UNFORESEEN CIRCUMSTANCES, AND TO ACCOUNT FOR CHANGING SITE CONDITIONS.
6. ANY AREAS OF DISTURBED SOIL THAT WILL NOT BE WORKED FOR TWO CONSECUTIVE DAYS DURING THE WET SEASON (OCT 1 TO APRIL 30) OR SEVEN DAYS DURING THE DRY SEASON (MAY 1 TO SEPT 30) SHALL BE IMMEDIATELY STABILIZED WITH APPROVED BMPS METHODS (E.G. STRAW, MULCH, PLASTIC COVERING, COLD MIX, ETC.)
7. GRADING AND/OR SOIL DISTURBING ACTIVITIES MAY BE LIMITED OR PROHIBITED FOR CERTAIN SITES SUBJECT TO ECA STANDARDS (I.E. ECA STEEP SLOPES, LANDSLIDE PRONE AREAS, ETC.) BETWEEN OCTOBER 31ST AND APRIL 1ST. IF NOTED IN THE GEOTECHNICAL SPECIAL INSPECTIONS REQUIREMENTS, A GRADING SEASON EXTENSION LETTER (GSEL) ISSUED BY SDCI IS REQUIRED FOR ALL GRADING AND/OR SOIL DISTURBING ACTIVITIES DURING THIS PERIOD. THE GEOTECHNICAL SPECIAL INSPECTOR MUST SUBMIT ELECTRONIC APPLICATIONS FOR A GSEL USING THE SDCI PROJECT PORTAL. ALLOW FOUR TO SIX WEEKS FOR PROCESSING. FAILURE TO OBTAIN THE GSEL PRIOR TO OCTOBER 31 MAY RESULT IN A WORK STOPPAGE.
8. CITY STREETS AND SIDEWALKS SHALL BE KEPT CLEAN AT ALL TIMES. NO MATERIAL SHALL BE STORED ON CITY STREETS OR SIDEWALKS WITHOUT A STREET USE PERMIT FROM THE SEATTLE DEPARTMENT OF TRANSPORTATION (SDOT).
9. POLLUTION CONTROL MEASURES SHALL BE FOLLOWED TO ENSURE THAT NO LIQUID PRODUCTS OR CONTAMINATED WATER ENTERS ANY STORM DRAINAGE FACILITIES OR OTHERWISE LEAVES THE PROJECT SITE. ANY HAZARDOUS MATERIALS OR LIQUID PRODUCTS THAT HAVE THE POTENTIAL TO POLLUTE RUNOFF SHALL BE STORED AND DISPOSED OF PROPERLY.
10. ENSURE THAT WASHOUT FROM CONCRETE TRUCKS IS PERFORMED OFF-SITE OR IN DESIGNATED CONCRETE WASHOUT AREAS ONLY. DO NOT WASH OUT CONCRETE TRUCKS ONTO THE GROUND, OR TO STORM DRAINS OR OPEN DITCHES. DO NOT DUMP EXCESS CONCRETE ONSITE, EXCEPT IN DESIGNATED CONCRETE WASHOUT AREAS.
11. ALL AREAS OF DISTURBED SOIL SHALL BE FULLY STABILIZED WITH THE APPROPRIATE SOIL AMENDMENT AND COVER MEASURES AT COMPLETION OF THE PROJECT. TYPICAL COVER MEASURES INCLUDE LANDSCAPING OR HYDROSEED WITH MULCH.

CARON

2505 3RD AVE #300C
SEATTLE WA 98121

T 206.367.1382 F 206.367.1385
W CARONARCHITECTURE.COM

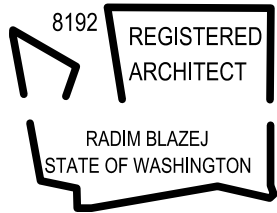

kpff

1601 5th Avenue, Suite 1600
Seattle, WA 98101
206.622.5822
www.kpff.com

MIDVALE
TOWNHOUSES

8839 MIDVALE AVE N
SEATTLE, WA 98103

SDCI # 6628930-CN

BUILDING PERMIT SUBMITTAL

DISCLAIMER

THIS SET OF DRAWINGS AND DOCUMENTS IS FOR BUILDING PERMIT SUBMITTAL ONLY AND DOES NOT CONSTITUTE A COMPLETE SET OF DOCUMENTS FOR ANY OTHER PURPOSE.

SUBMITTAL /REVISION	DATE
BUILDING PERMIT SUBMITTAL	05.17.2018
BUILDING PERMIT RE-SUBMITTAL	01.07.2019

STAMP

THE CITY OF SEATTLE
DEPARTMENT OF CONSTRUCTION &
INSPECTIONS
APPROVED
Subject to Errors and Omissions
03/04/2019

SHEET TITLE

GENERAL NOTES

SHEET NUMBER

C0.01

CARON PROJECT NO. 17_085

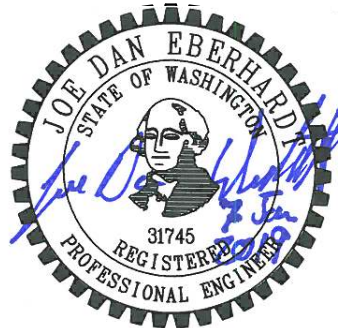

MIDVALE
TOWNHOUSES8839 MIDVALE AVE N
SEATTLE, WA 98103SDCI # 6628930-CN
BUILDING PERMIT SUBMITTAL

DISCLAIMER
THIS SET OF DRAWINGS AND DOCUMENTS IS FOR
BUILDING PERMIT SUBMITTAL ONLY AND DOES NOT
CONSTITUTE A COMPLETE SET OF DOCUMENTS FOR
ANY OTHER PURPOSE.

SUBMITTAL / REVISION	DATE
BUILDING PERMIT SUBMITTAL	05.17.2018
BUILDING PERMIT RE-SUBMITTAL	01.07.2019

POST CONSTRUCTION SOIL MANAGEMENT PLAN

AT THE END OF PROJECT, ALL AREAS DISTURBED AND NOT COVERED WITH A HARD SURFACE MUST BE AMENDED PER THE SOIL AMENDMENT DETAIL BELOW AND PROBE TO 12-INCHES AT THE SITE FINAL INSPECTION.

- LABEL ALL AREAS DISTURBED AND NOT COVERED WITH A HARD SURFACE WITHIN THE SITE AS ONE OF THE FOLLOWING: SA (SOIL AMENDMENT AREA) or ND (NON-DISTURBED AREA). SEE DEFINITIONS BELOW. DO NOT REFERENCE AN ALTERNATE PLAN SHEET.
- AN ESTIMATE OF THE VOLUME OF COMPOST REQUIRED IS AUTOMATICALLY CALCULATED ON THE SITE AND DRAINAGE CONTROL SUMMARY SHEET REQUIRED ON THE DRAINAGE AND WASTEWATER CONTROL PLAN (DWG PLAN). THE ACTUAL VOLUME OF COMPOST REQUIRED WILL BE DETERMINED IN THE FIELD.

DEFINITIONS:

- NON-DISTURBED AREA (ND): VEGETATED AREAS THAT WILL NOT BE SUBJECT TO LAND DISTURBING ACTIVITY (SEE D) DO NOT REQUIRE SOIL AMENDMENT IF THEY ARE FENCED AND CONTINUOUSLY PROTECTED THROUGHOUT CONSTRUCTION. THE FENCING MUST BE IN PLACE AT THE FIRST GROUND DISTURBANCE INSPECTION. THIS WILL BE MONITORED BY THE DPO SITE INSPECTOR. NO DISTURBANCE, INCLUDING VEHICLE TRAFFIC OR MATERIAL STORAGE, IS ALLOWED IN THESE AREAS UNTIL FINAL INSPECTION. LABEL THESE AREAS AS (ND) IN THE PLAN VIEW.
- SOIL AMENDMENT AREA (SA): VEGETATED OR COMPOST AREAS (TURF AND LANDSCAPE) MUST BE AMENDED PER THE SOIL AMENDMENT DETAIL AND THE SUBSOIL MUST BE LOOSENEED SO IT WILL PROBE TO A DEPTH OF 12 INCHES PRIOR TO SITE FINAL INSPECTION. THIS INCLUDES AREAS IMPACTED BY CLEARING AND GRADING, STOCKPILING, SITE ACCESS, PATHWAYS AND MATERIALS OR EQUIPMENT STORAGE. LABEL THESE AREAS AS (SA) IN THE PLAN VIEW.

SOIL AMENDMENT

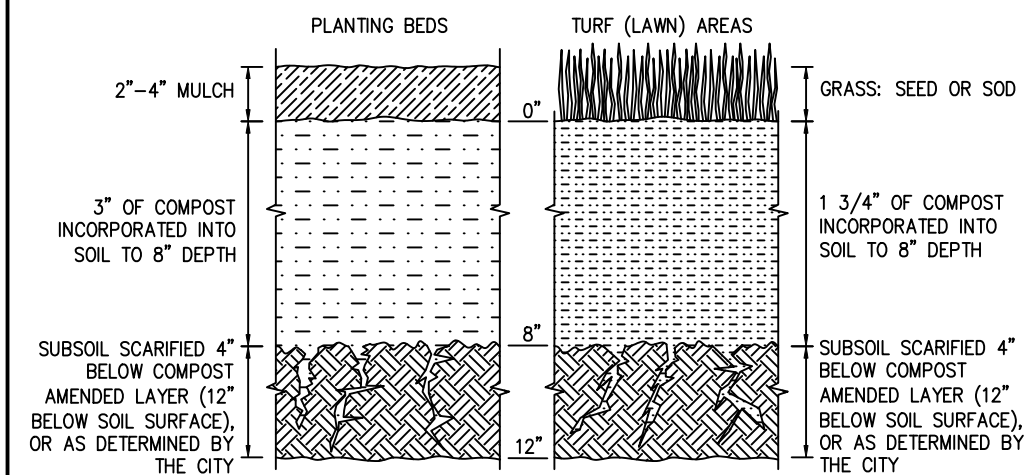

NOTES:

1. POST CONSTRUCTION SOIL AMENDMENT IS REQUIRED ON ALL AREAS NOT COVERED BY IMPERVIOUS SURFACE WHERE SOIL IS DISTURBED DURING CONSTRUCTION.
2. SOIL AMENDMENT MUST PASS A 12 INCH MINIMUM PROBE TEST.

SYMBOL: (SA) AREA REQUIRING SOIL AMENDMENT (ND) NON-DISTURBED AREA (SOIL AMENDMENT NOT REQUIRED)

TESC NOTES:

1. CONSTRUCTION SITE STORMWATER POLLUTION PREVENTION CONTROL SHALL BE PROVIDED IN ACCORDANCE WITH SEATTLE MUNICIPAL CODE SECTION 22.805.020.
2. IF REQUIRED, OBTAIN AN SDCI SIDE SEWER PERMIT FOR TEMPORARY DEWATERING PRIOR TO BUILDING PERMIT ISSUANCE.
3. PROVIDE CATCH BASIN/INLET PROTECTION TO ALL DOWNSTREAM INLETS AND CATCH BASINS WITHIN 500 FEET OF THE PROPERTY.
4. CONTRACTOR SHALL FIELD LOCATE AND ADJUST LOCATION OF EROSION CONTROL ELEMENTS TO MATCH SITE CONDITIONS THROUGH CONSTRUCTION.
5. MINIMUM ESTIMATED SETTLING TANK SIZE IS 1,740 GALLONS. ADJUST TANK SIZE AS NEEDED TO MEET DISCHARGE WATER QUALITY REQUIREMENTS.
6. IF CONSTRUCTION LAYDOWN AREAS ARE EXTENDED INTO THE RIGHT-OF-WAY, CONTRACTOR SHALL OBTAIN A STREET USE PERMIT FROM THE CITY.

LEGEND:

- APPROXIMATE LIMIT OF CONSTRUCTION
- CONSTRUCTION FENCE
- >- INTERCEPTOR DITCH
- X- COMPOST SOCK
- X- FILTER FENCE
- CB/INLET PROTECTION
- X- STABILIZED CONSTRUCTION ENTRANCE



0 5 10 20
1 inch = 10 feet

STAMP

THE CITY OF SEATTLE
DEPARTMENT OF CONSTRUCTION &
INSPECTIONS
APPROVED
Subject to Errors and Omissions
03/04/2019

SHEET TITLE

TESC PLAN

SHEET NUMBER

C1.00

CARON PROJECT NO. 17_085

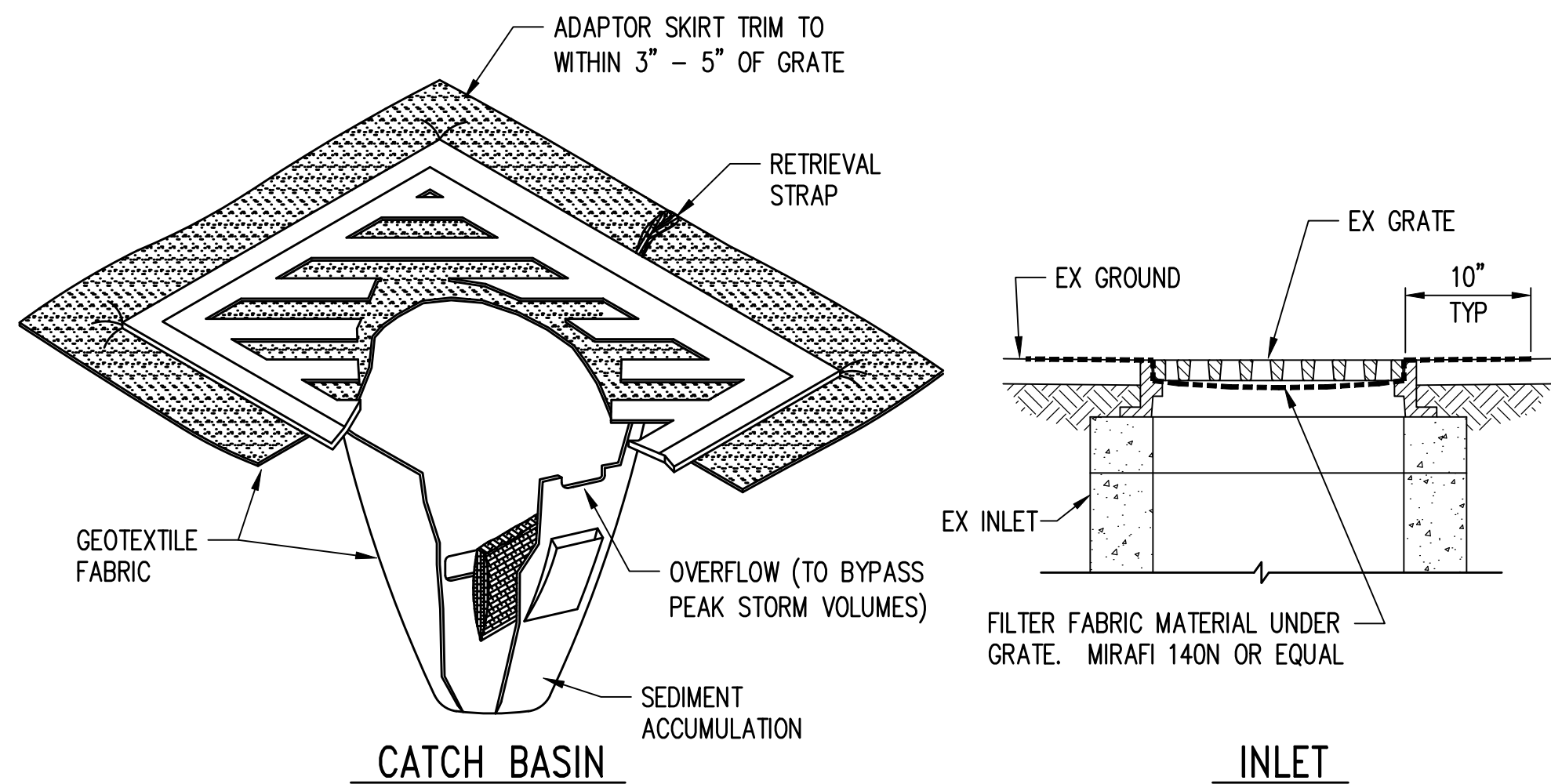

NOTES:

1. CB/INLET INSERTS NEED TO BE REMOVED AT THE END OF THE JOB.
2. CB/INLET INSERTS ARE ONLY TO BE INSTALLED IN DRAINAGE DEVICES PER THE MANUFACTURER'S RECOMMENDATIONS. CATCH BASIN INLET INSERTS ARE NOT TO BE INSTALLED IN CURB INLETS.
3. INLET INSERTS SHALL BE INSPECTED AND MAINTAINED WHEN A 1/2 INCH RAIN ACCUMULATES WITHIN A 24 HOUR PERIOD.
4. CB/INLET INSERTS SHALL BE INSTALLED PRIOR TO CLEARING AND GRADING ACTIVITY, OR UPON PLACEMENT OF A NEW CATCH BASIN.
5. SEDIMENT SHALL BE REMOVED FROM THE UNIT WHEN IT BECOMES 1/3 FULL OR MANUFACTURER'S INSTRUCTIONS.
6. SEDIMENT REMOVAL SHALL BE ACCOMPLISHED BY REMOVING THE CB/INLET INSERTS, EMPTYING, AND RE-INSERTING IT INTO THE CATCH BASIN/INLET.

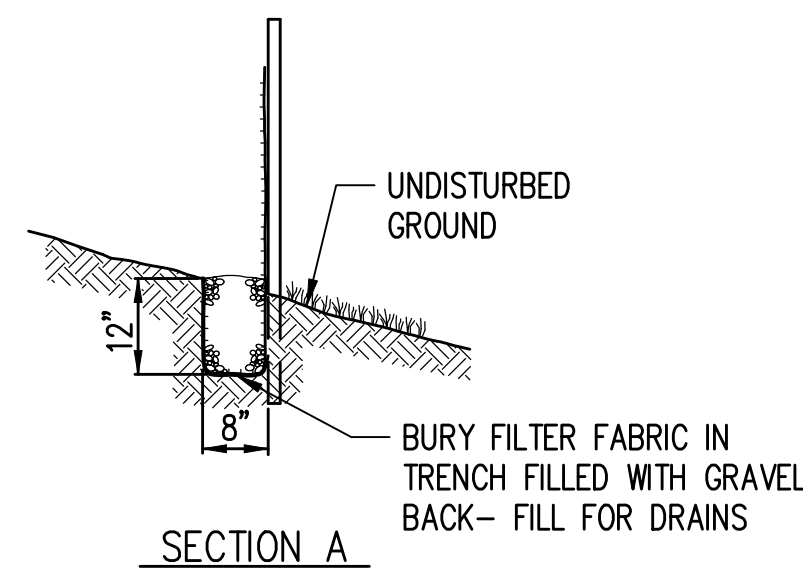
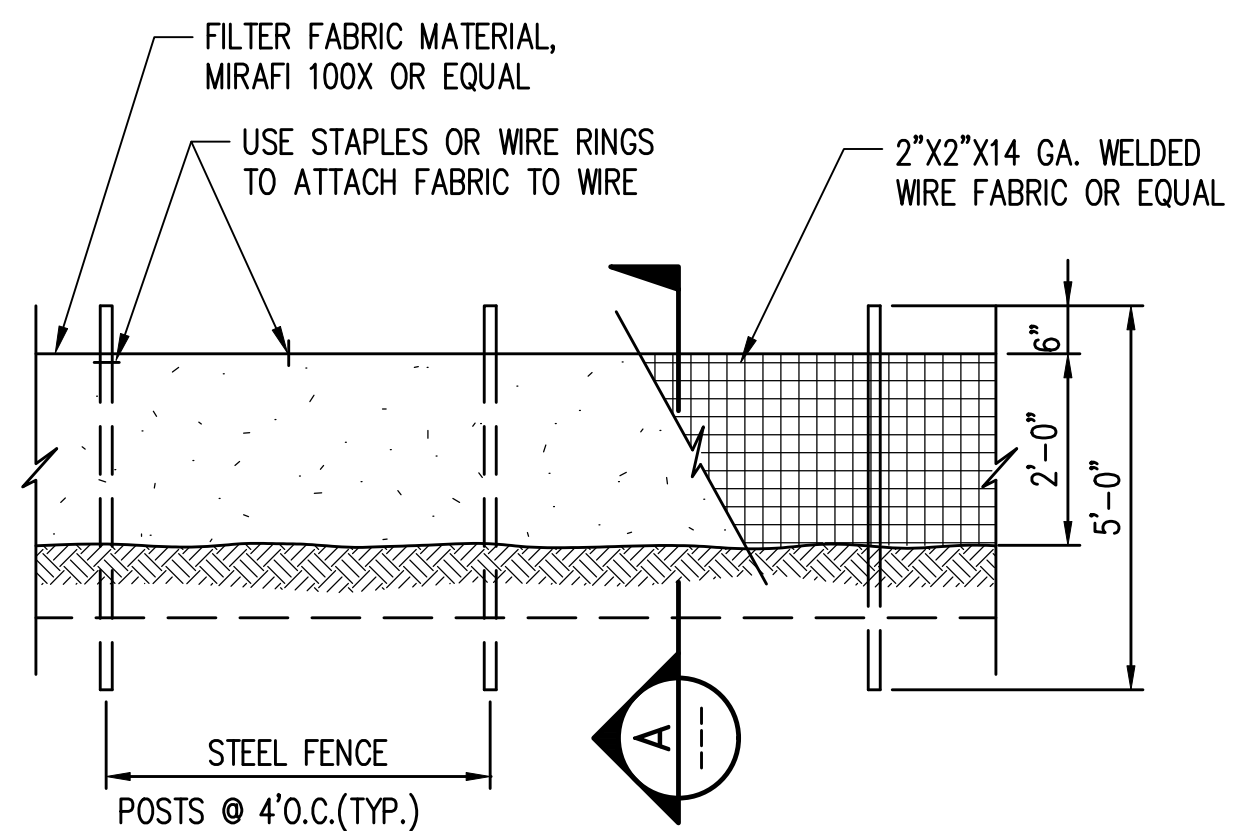

NOTE:

UPON COMPLETION OF THE PROJECT OR WHEN DIRECTED BY THE INSPECTOR, THE FILTER FENCE SHALL BE REMOVED IN ITS ENTIRETY AND DISPOSED OF BY THE CONTRACTOR.

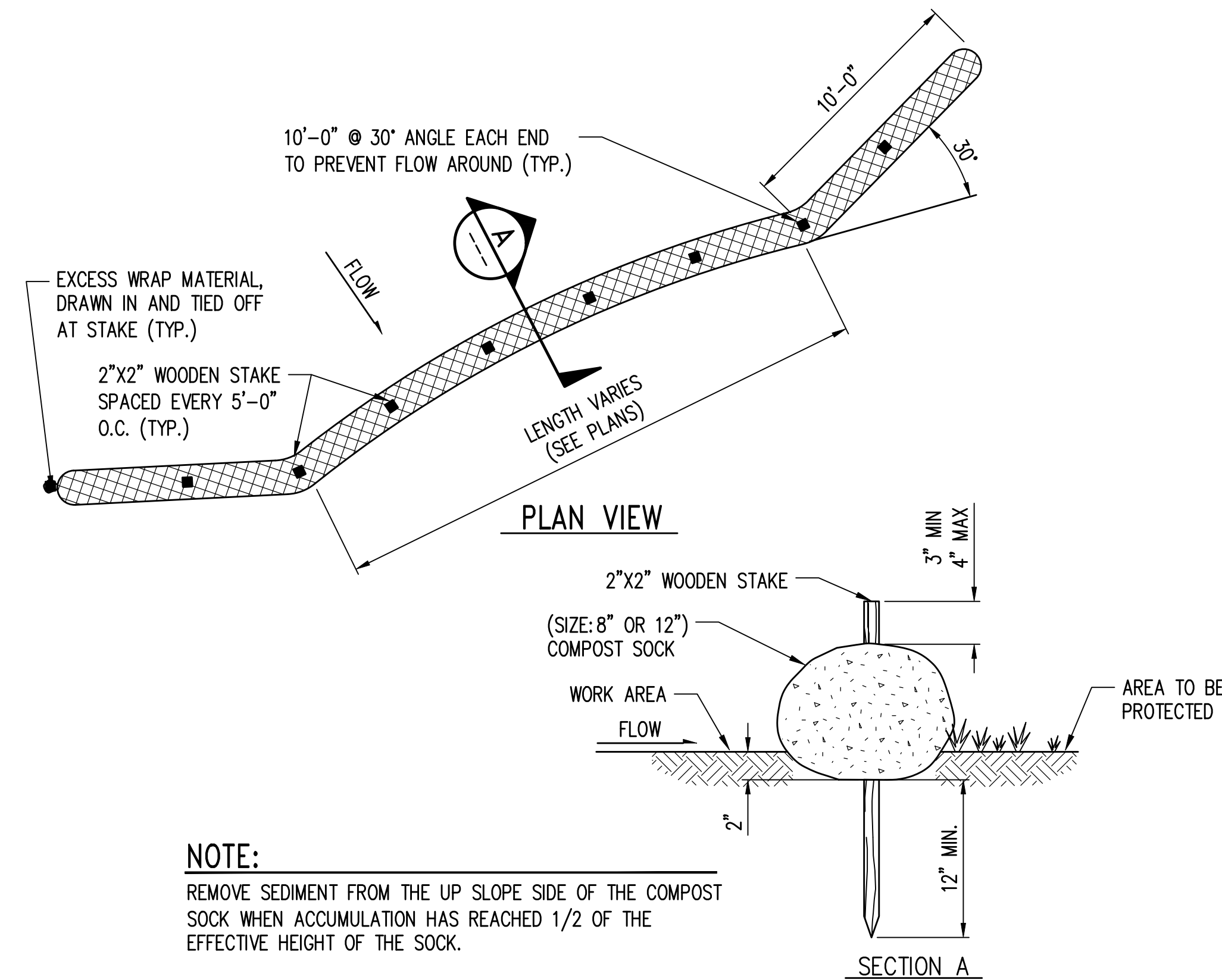

NOTE:

REMOVE SEDIMENT FROM THE UP SLOPE SIDE OF THE COMPOST SOCK WHEN ACCUMULATION HAS REACHED 1/2 OF THE EFFECTIVE HEIGHT OF THE SOCK.

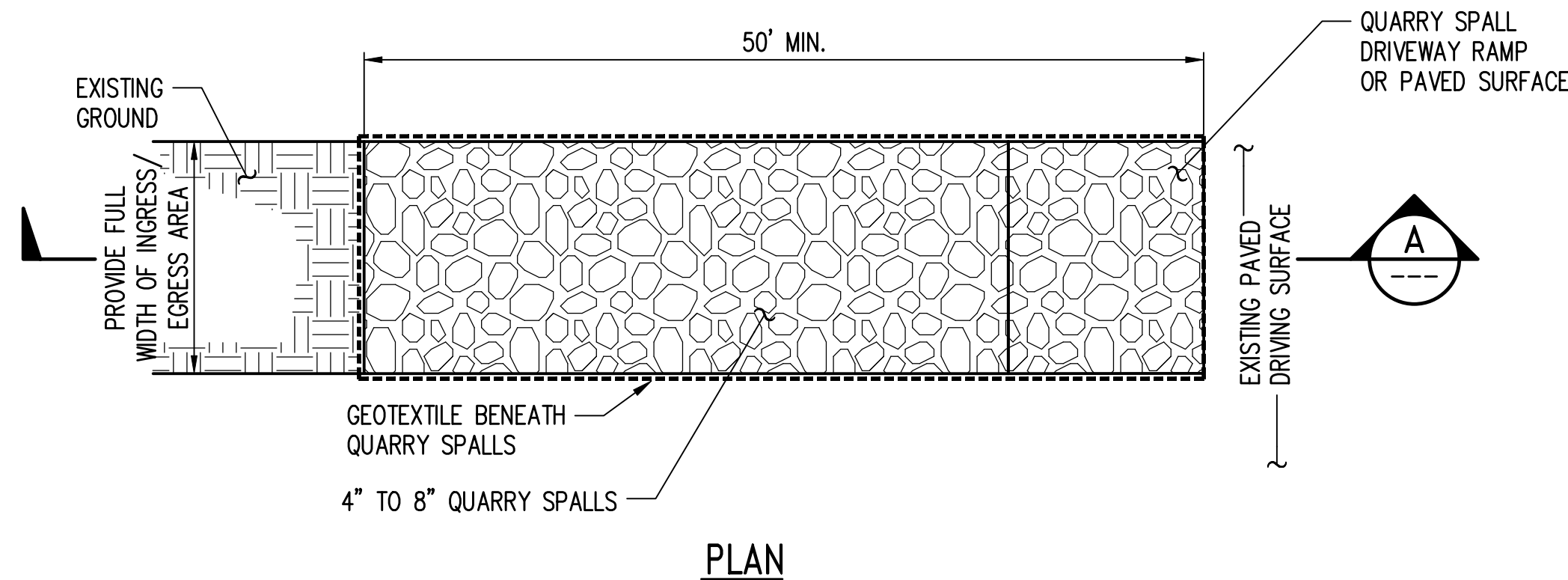
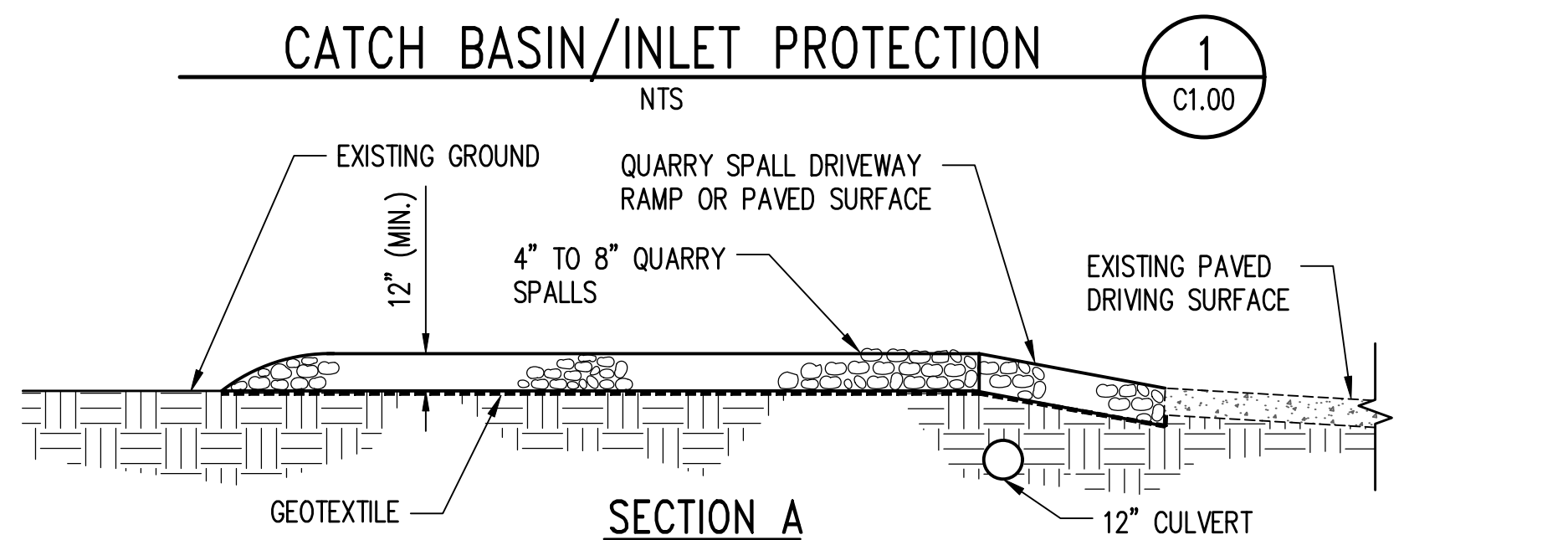

MAINTENANCE STANDARDS

1. QUARRY SPALLS SHALL BE ADDED IF THE PAD IS NO LONGER IN ACCORDANCE WITH THE SPECIFICATIONS.
2. IF THE ENTRANCE IS NOT PREVENTING SEDIMENT FROM BEING TRACKED ONTO PAVEMENT, THEN ALTERNATIVE MEASURES TO KEEP THE STREETS FREE OF SEDIMENT SHALL BE USED. THIS MAY INCLUDE STREET SWEEPING, AN INCREASE IN THE DIMENSIONS OF THE ENTRANCE, OR THE INSTALLATION OF A WHEEL WASH. IF WASHING IS USED, IT SHALL BE DONE ON AN AREA COVERED WITH CRUSHED ROCK, AND WASH WATER SHALL DRAIN TO TREATMENT BMP SUCH AS A SETTLING TANK OR A SEDIMENT TRAP.
3. ANY SEDIMENT THAT IS TRACKED ONTO PAVEMENT SHALL BE REMOVED IMMEDIATELY BY SWEEPING. THE SEDIMENT COLLECTED BY SWEEPING SHALL BE REMOVED OR STABILIZED ON-SITE. THE PAVEMENT SHALL NOT BE CLEANED BY WASHING DOWN THE STREET, EXCEPT WHEN SWEEPING IS INEFFECTIVE AND THERE IS A THREAT TO PUBLIC SAFETY. IF IT IS NECESSARY TO WASH THE STREETS, THE CONSTRUCTION OF A SMALL SUMP SHALL BE CONSIDERED. THE SEDIMENT WOULD THEN BE WASHED INTO THE SUMP.
4. ANY QUARRY SPALLS THAT ARE LOOSENEED FROM THE PAD AND END UP ON THE ROADWAY SHALL BE REMOVED IMMEDIATELY.
5. IF VEHICLES ARE ENTERING OR EXITING THE SITE AT POINTS OTHER THAN THE CONSTRUCTION ENTRANCE(S), FENCING SHALL BE INSTALLED TO CONTROL TRAFFIC.

1 FILTER FENCE

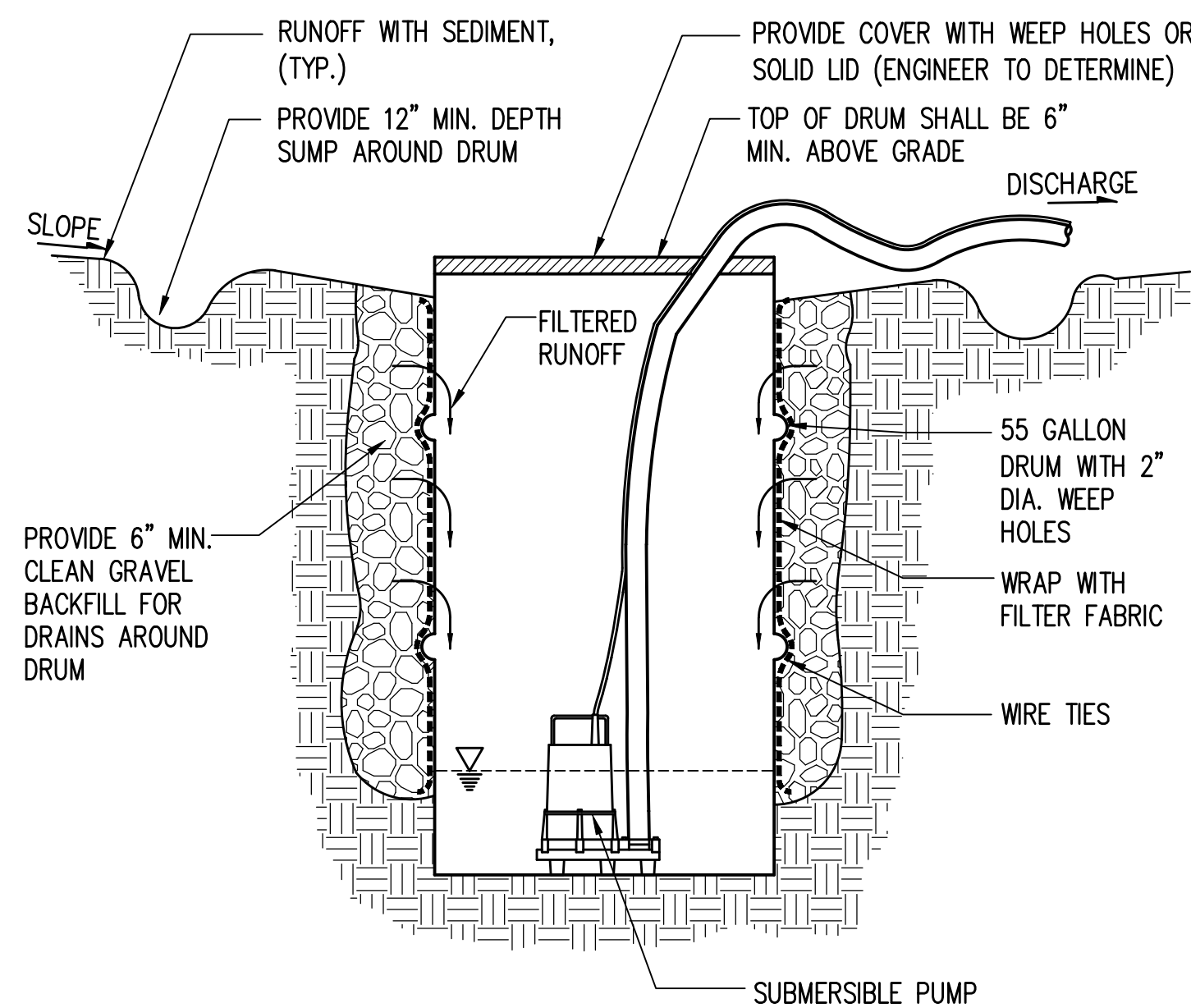

NOTE:

PUMP SHALL BE SUBMERSIBLE AND HAVE A MIN. CAPACITY OF 0.03 CFS (15 GPM).

5 MOBILE 55 GALLON DRUM WITH PUMP

3 COMPOST SOCK

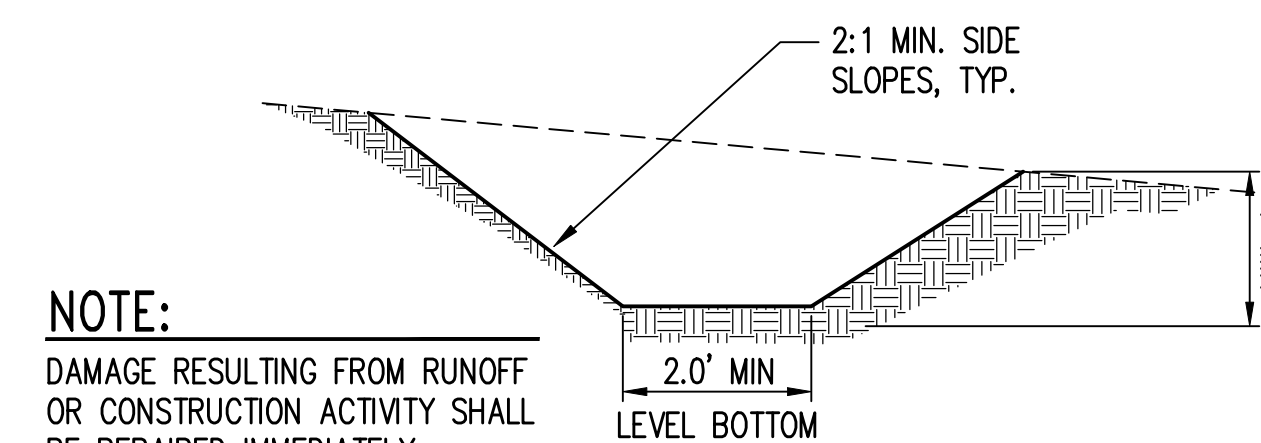

NOTE:

DAMAGE RESULTING FROM RUNOFF OR CONSTRUCTION ACTIVITY SHALL BE REPAIRED IMMEDIATELY.

INTERCEPTOR DITCH

CARON

2505 3RD AVE #300C
SEATTLE WA 98121

T 206.367.1382 F 206.367.1385
W CARONARCHITECTURE.COM

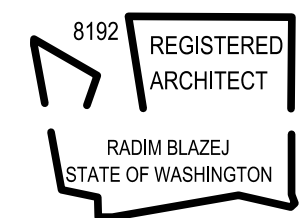

kpff

1601 5th Avenue, Suite 1600
Seattle, WA 98101
206.622.5822
www.kpff.com

MIDVALE TOWNHOUSES

8839 MIDVALE AVE N
SEATTLE, WA 98103

SDCI # 6628930-CN BUILDING PERMIT SUBMITTAL

DISCLAIMER
THIS SET OF DRAWINGS AND DOCUMENTS IS FOR BUILDING PERMIT SUBMITTAL ONLY AND DOES NOT CONSTITUTE A COMPLETE SET OF DOCUMENTS FOR ANY OTHER PURPOSE.

SUBMITTAL / REVISION	DATE
BUILDING PERMIT SUBMITTAL	05.17.2018
BUILDING PERMIT RE-SUBMITTAL	01.07.2019

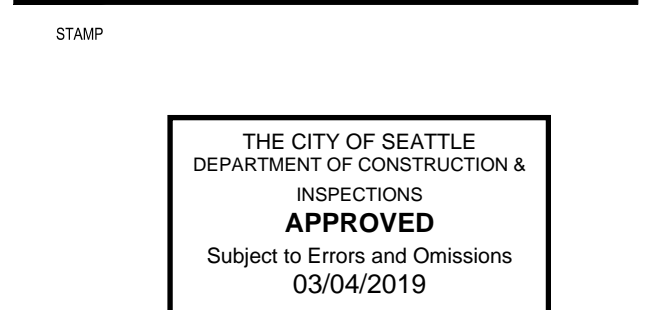

SHEET TITLE
TESC DETAILS

SHEET NUMBER

C1.01

CARON PROJECT NO. 17_085



4 STABILIZED CONSTRUCTION ENTRANCE

Z:\1700001-1700990\1700990\1700990 Midvale Ave\CAD\Design\OnSite\MW-C6.00-01.dwg

Ad661T

Jan 07, 2019 - 3:19pm

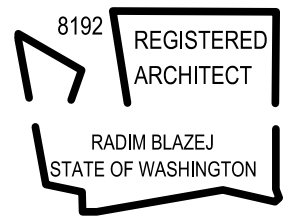

kpff

1601 5th Avenue, Suite 1600
Seattle, WA 98101
206.622.5822
www.kpff.comMIDVALE
TOWNHOUSES8839 MIDVALE AVE N
SEATTLE, WA 98103SDCI # 6628930-CN
BUILDING PERMIT SUBMITTAL

DISCLAIMER

THIS SET OF DRAWINGS AND DOCUMENTS IS FOR
BUILDING PERMIT SUBMITTAL ONLY AND DOES NOT
CONSTITUTE A COMPLETE SET OF DOCUMENTS FOR
ANY OTHER PURPOSE.

SUBMITTAL / REVISION	DATE
BUILDING PERMIT SUBMITTAL	05.17.2018
BUILDING PERMIT RE-SUBMITTAL	01.07.2019

STAMP

THE CITY OF SEATTLE
DEPARTMENT OF CONSTRUCTION &
INSPECTIONS
APPROVED
Subject to Errors and Omissions
03/04/2019

SHEET TITLE

SITE PAVING &
HORIZONTAL CONTROL

SHEET NUMBER

C2.00

CARON PROJECT NO. 17_085

NOTES:

- SEE LANDSCAPE ARCHITECT'S PLANS FOR
HARDSCAPING DIMENSIONS, MATERIALS AND
SCORING PATTERNS.
- 4 PANELS OF RIGID PAVEMENT TO BE RESTORED
PER COS DR 01-2017.

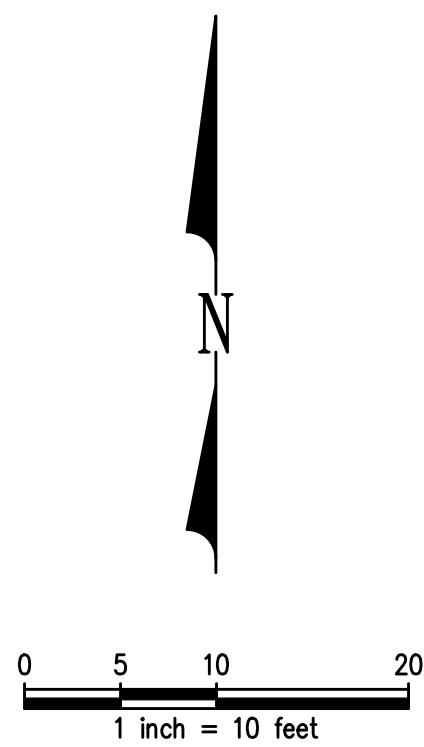
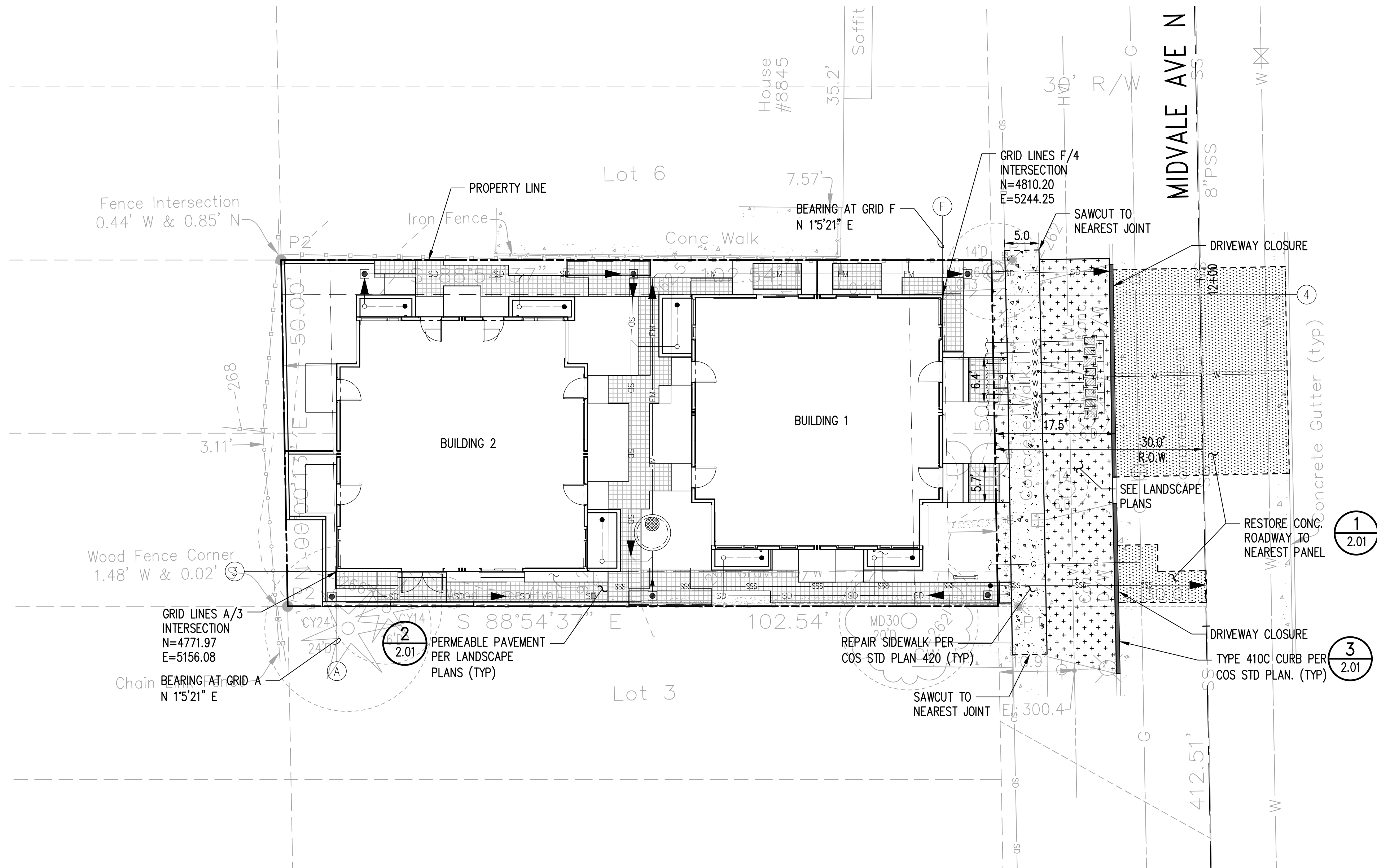



8839 MIDVALE AVE N
SEATTLE, WA 98103

DISCLAIMER
THIS SET OF DRAWINGS AND DOCUMENTS IS FOR
BUILDING PERMIT SUBMITTAL ONLY AND DOES NOT
CONSTITUTE A COMPLETE SET OF DOCUMENTS FOR
ANY OTHER PURPOSE.

SUBMITTAL / REVISION	DATE
BUILDING PERMIT SUBMITTAL	05.17.2018
BUILDING PERMIT RE-SUBMITTAL	01.07.2019

STAMP



SHEET TITLE

PAVING DETAILS

SHEET NUMBER _____

CARON PROJECT NO. 17.085

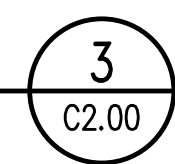
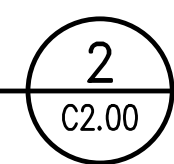
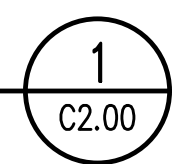
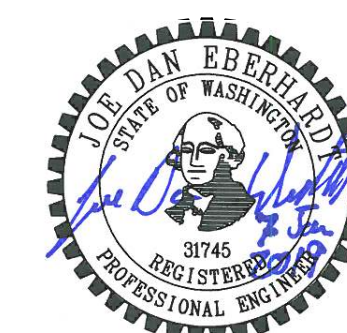

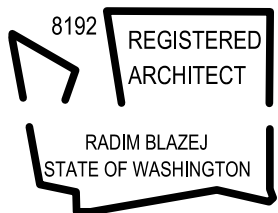

kpff

1601 5th Avenue, Suite 1600
Seattle, WA 98101
206.622.5822
www.kpff.comMIDVALE
TOWNHOUSES8839 MIDVALE AVE N
SEATTLE, WA 98103SDCI # 6628930-CN
BUILDING PERMIT SUBMITTAL

DISCLAIMER

THIS SET OF DRAWINGS AND DOCUMENTS IS FOR
BUILDING PERMIT SUBMITTAL ONLY AND DOES NOT
CONSTITUTE A COMPLETE SET OF DOCUMENTS FOR
ANY OTHER PURPOSE.

SUBMITTAL / REVISION	DATE
BUILDING PERMIT SUBMITTAL	05.17.2018
BUILDING PERMIT RE-SUBMITTAL	01.07.2019

STAMP

THE CITY OF SEATTLE
DEPARTMENT OF CONSTRUCTION &
INSPECTIONS
APPROVED
Subject to Errors and Omissions
03/04/2019

SHEET TITLE

GRADING & STORM DRAINAGE
PLAN

SHEET NUMBER

C3.00

CARON PROJECT NO. 17_085

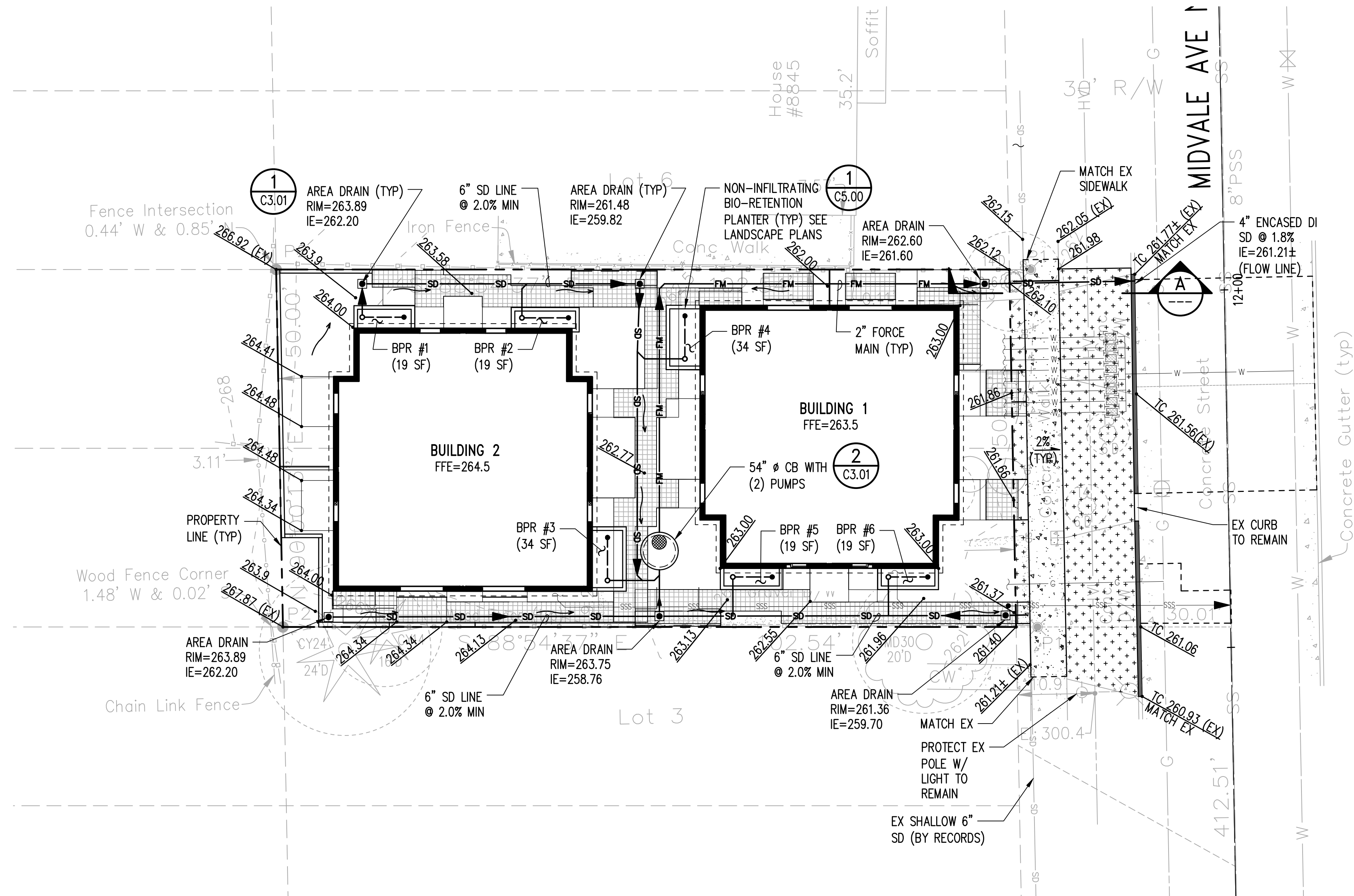

NOTES:

- SEE ARCHITECTURAL AND LANDSCAPE PLANS FOR ADDITIONAL DETAILS FOR PLANTERS, SITE WALLS, STAIRS, LANDSCAPE, AND OTHER SITE FEATURES.
- FINISH FLOOR ELEVATIONS ARE SHOWN FOR REFERENCE ONLY. SEE ARCHITECTURAL PLANS FOR SLAB AND FINISHED FLOOR ELEVATIONS.
- DOWNSPOUTS SHALL DISCHARGE DIRECTLY TO BIORETENTION PLANTERS, PER ARCHITECTURAL PLANS.
- ALL BIORETENTION PLANTERS SHALL HAVE AT MINIMUM 6" PONDING DEPTH AND 2" FREEBOARD.
- THE 54" DIAMETER CB IS THE ESTIMATED SIZE REQUIRED TO HOUSE TWO PUMPS. CONTRACTOR TO VERIFY BASED ON PUMP SIZE CHOSEN.

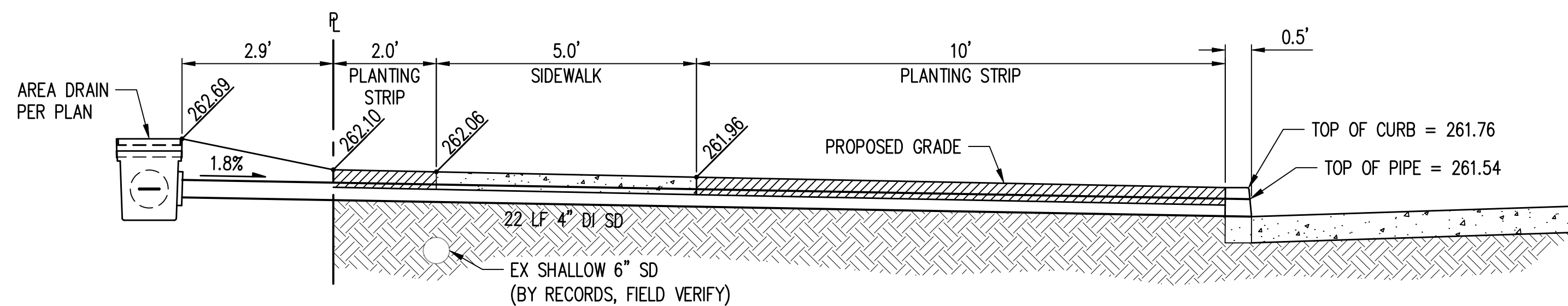

STORM DRAIN SECTION

SCALE: 1" = 2'

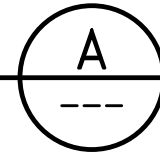
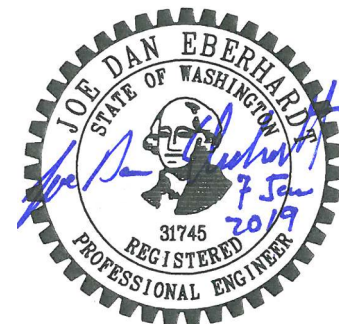
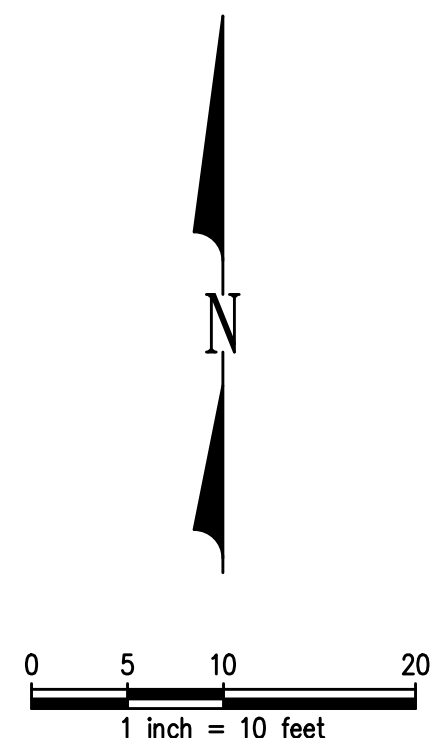
0 1 2 4
1 inch = 2 feet

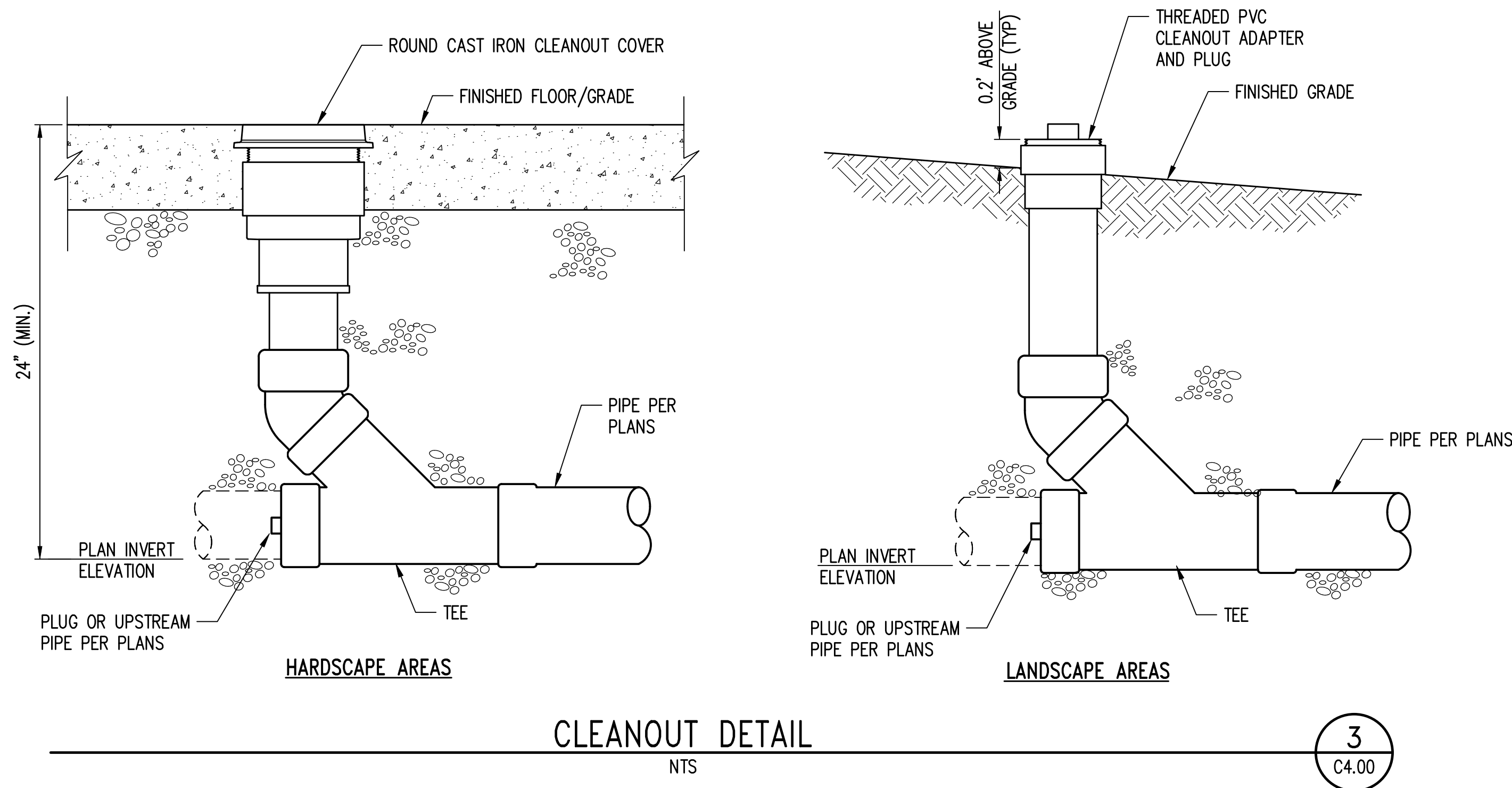
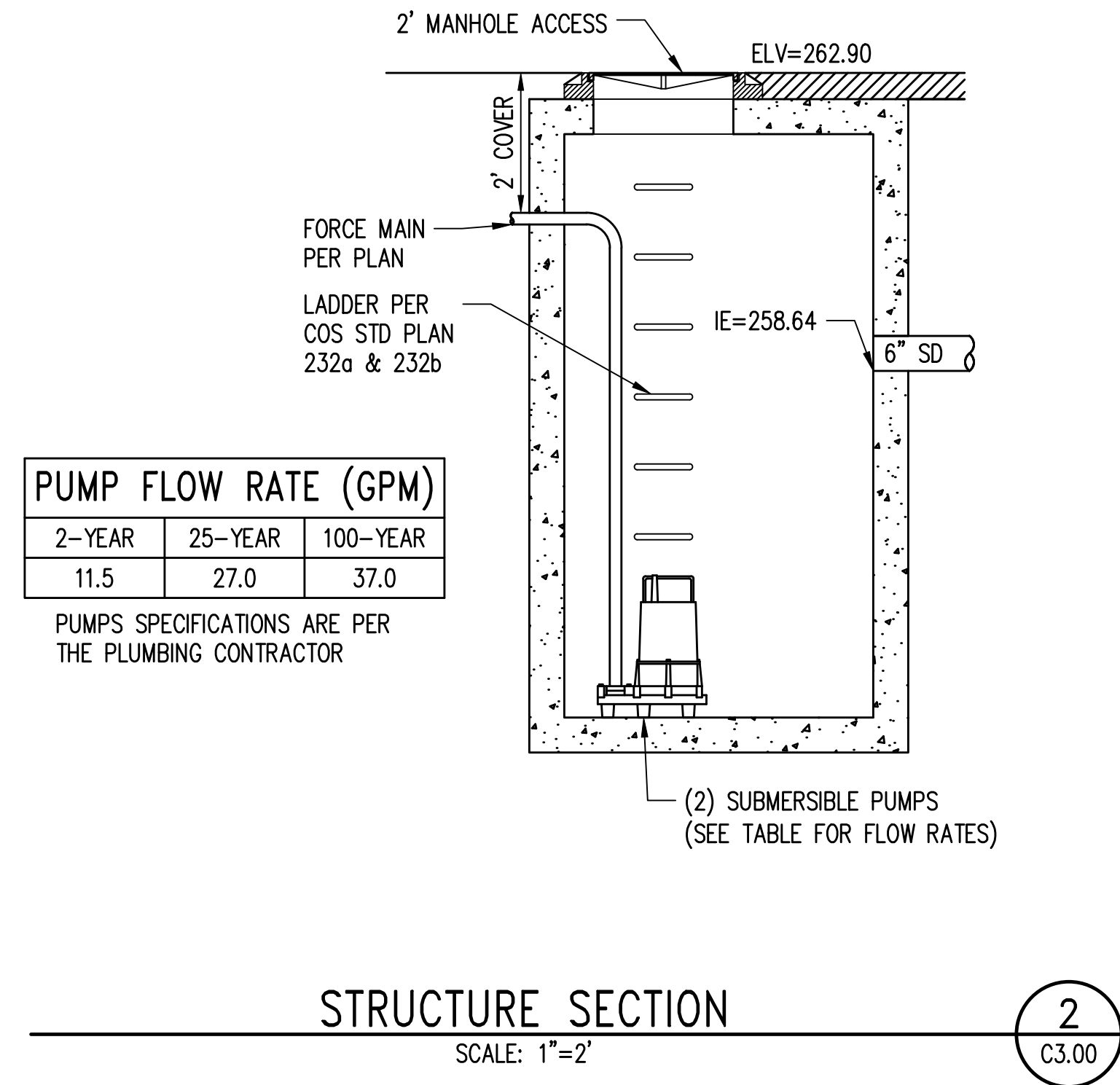
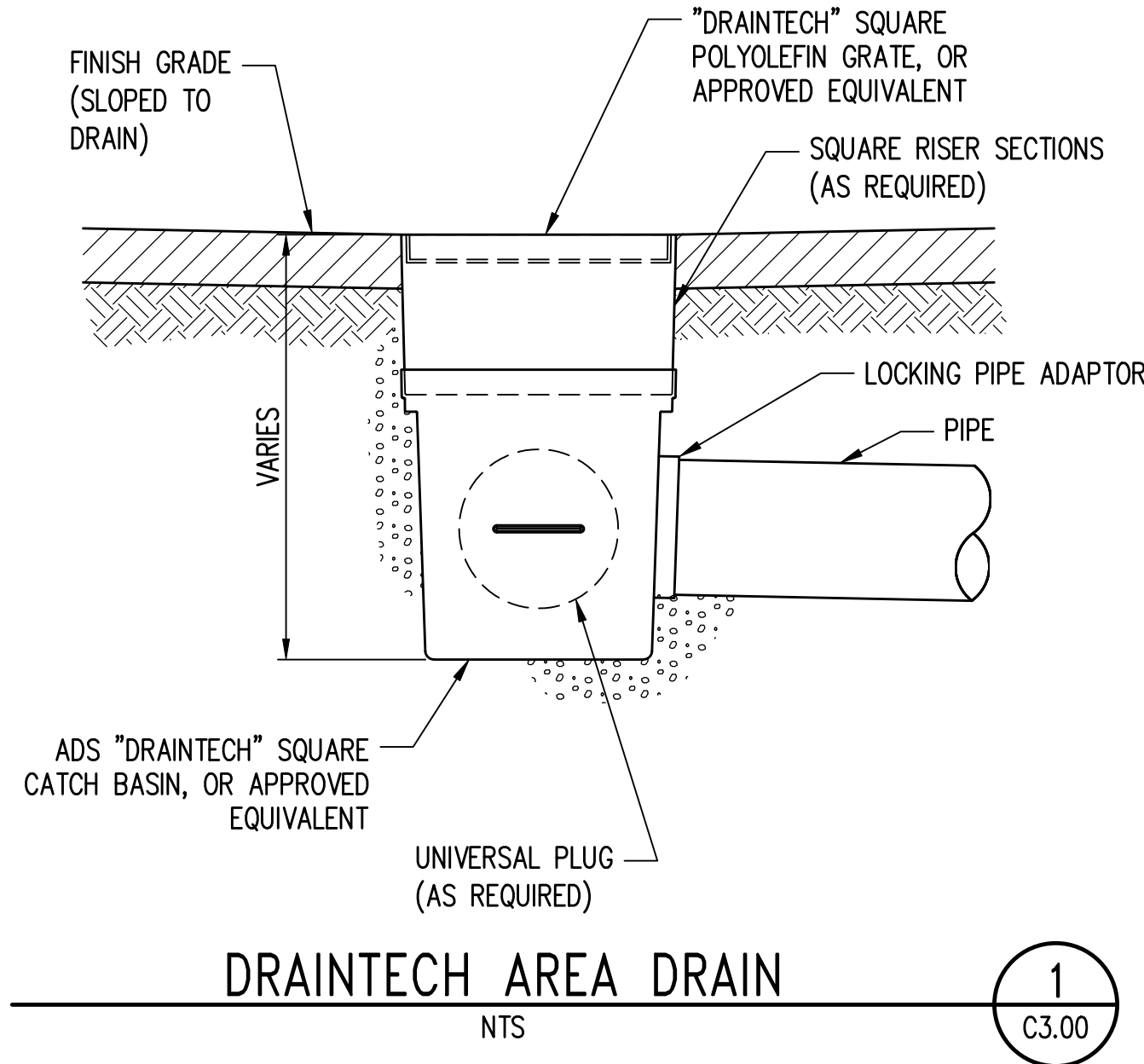

CARON

2505 3RD AVE #300C
SEATTLE WA 98121

T 206.367.1382 F 206.367.1385
W CARONARCHITECTURE.COM

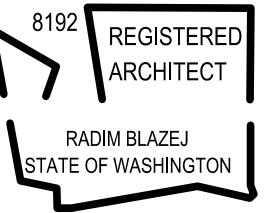

kpff

1601 5th Avenue, Suite 1600
Seattle, WA 98101
206.622.5822
www.kpff.com

MIDVALE TOWNHOUSES

8839 MIDVALE AVE N
SEATTLE, WA 98103

SDCI # 6628930-CN

BUILDING PERMIT SUBMITTAL

DISCLAIMER
THIS SET OF DRAWINGS AND DOCUMENTS IS FOR
BUILDING PERMIT SUBMITTAL ONLY AND DOES NOT
CONSTITUTE A COMPLETE SET OF DOCUMENTS FOR
ANY OTHER PURPOSE.

SUBMITTAL / REVISION	DATE
BUILDING PERMIT SUBMITTAL	05.17.2018
BUILDING PERMIT RE-SUBMITTAL	01.07.2019

STAMP

THE CITY OF SEATTLE
DEPARTMENT OF CONSTRUCTION &
INSPECTIONS
APPROVED
Subject to Errors and Omissions
03/04/2019

SHEET TITLE

STORM DRAIN DETAILS

SHEET NUMBER

C3.01

CARON PROJECT NO. 17_085

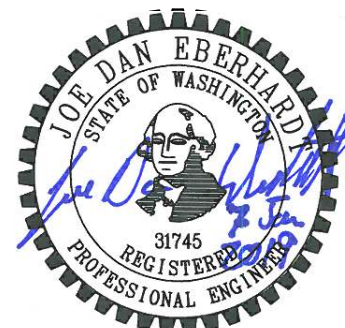

Z:\1700001-1700999\1700999-8839 Midvale Ave\CADD\Design\OnSite\WP-C3.00-01.dwg

Adaf6t

Jan 07, 2019 - 3:20pm

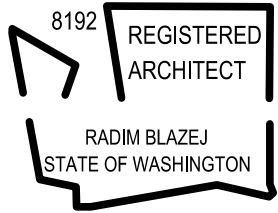

kpff

1601 5th Avenue, Suite 1600
Seattle, WA 98101
206.622.5822
www.kpff.comMIDVALE
TOWNHOUSES8839 MIDVALE AVE N
SEATTLE, WA 98103SDCI # 6628930-CN
BUILDING PERMIT SUBMITTAL

DISCLAIMER

THIS SET OF DRAWINGS AND DOCUMENTS IS FOR BUILDING PERMIT SUBMITTAL ONLY AND DOES NOT CONSTITUTE A COMPLETE SET OF DOCUMENTS FOR ANY OTHER PURPOSE.

SUBMITTAL / REVISION	DATE
BUILDING PERMIT SUBMITTAL	05.17.2018
BUILDING PERMIT RE-SUBMITTAL	01.07.2019

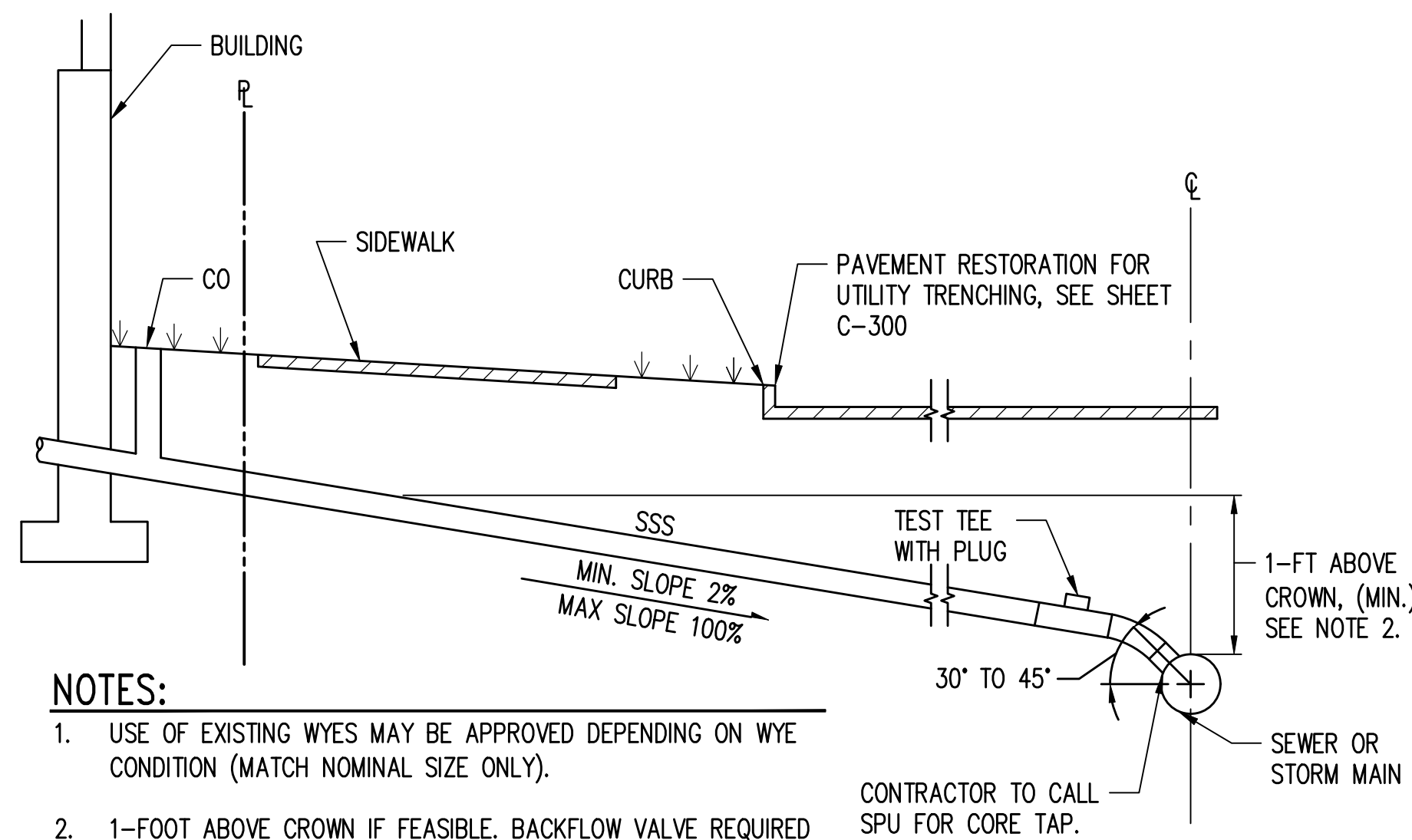
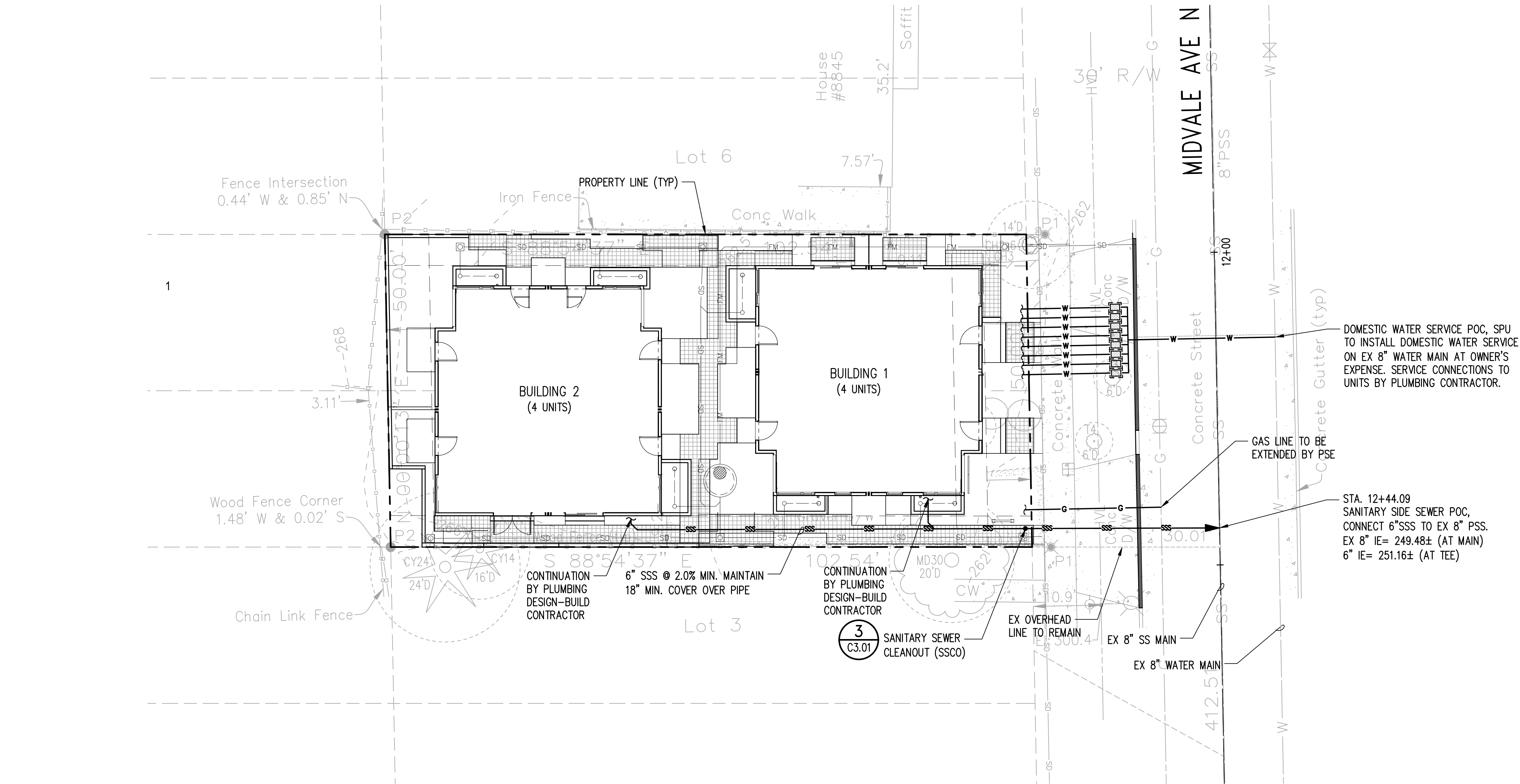

NOTES:

- USE OF EXISTING WYES MAY BE APPROVED DEPENDING ON WYE CONDITION (MATCH NOMINAL SIZE ONLY).
- 1-FOOT ABOVE CROWN IF FEASIBLE. BACKFLOW VALVE REQUIRED IF UNABLE TO PROVIDE ELEVATIONS DIFFERENCE, OR HOLD HARMLESS INDEMNITY TO BE RECORDED.

TYP. SSS CONNECTION DETAIL

NTS

NOTES:

- TRENCHING AND BEDDING FOR SANITARY SIDE SEWER SHALL BE PER COS STD PLANS 284 AND 285, AND SHALL BE INSTALLED IN ACCORDANCE WITH DIRECTOR'S RULE 4-2011. SEE GENERAL SIDE SEWER NOTES ON SHEET C0.01.
- TRENCHING AND BEDDING FOR WATER SERVICE SHALL BE PER COS STD PLAN 350. BEDDING MATERIAL SHALL BE TYPE 9 MINERAL AGGREGATE.
- PENETRATION OF UTILITY LINES THROUGH BUILDING AND FOUNDATION WALLS TO BE COORDINATED WITH PLUMBING CONTRACTOR AND STRUCTURAL PLANS.
- CONNECTIONS TO EXISTING WATER MAINS TO BE PERFORMED BY SPU AT OWNER'S EXPENSE. NEW SERVICE LINES WILL BE EXTENDED TO PROPERTY LINE BUY SPU AND WILL ALSO INCLUDE METER INSTALLATION AND BACKFILL. CONTRACTOR TO COORDINATE WITH SPU.
- EX SANITARY CONNECTION IS NOT SHOWN ON THE SURVEY. THE CONTRACTOR SHALL CAP ALL THE EX UTILITIES AT THE PROPERTY LINE.

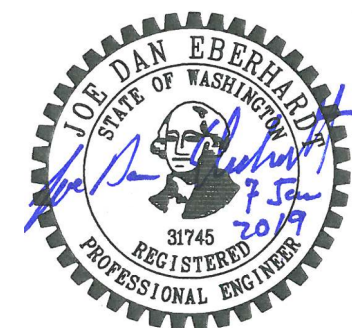
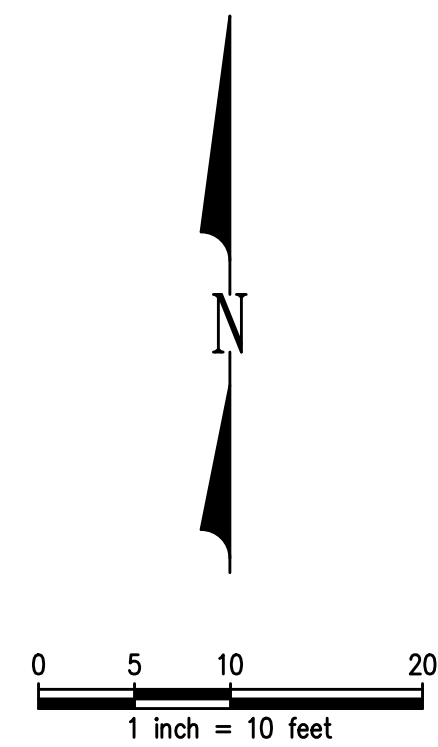

STAMP

THE CITY OF SEATTLE
DEPARTMENT OF CONSTRUCTION &
INSPECTIONS
APPROVED
Subject to Errors and Omissions
03/04/2019

SHEET TITLE

UTILITY PLAN

SHEET NUMBER

C4.00

CARON PROJECT NO. 17.085

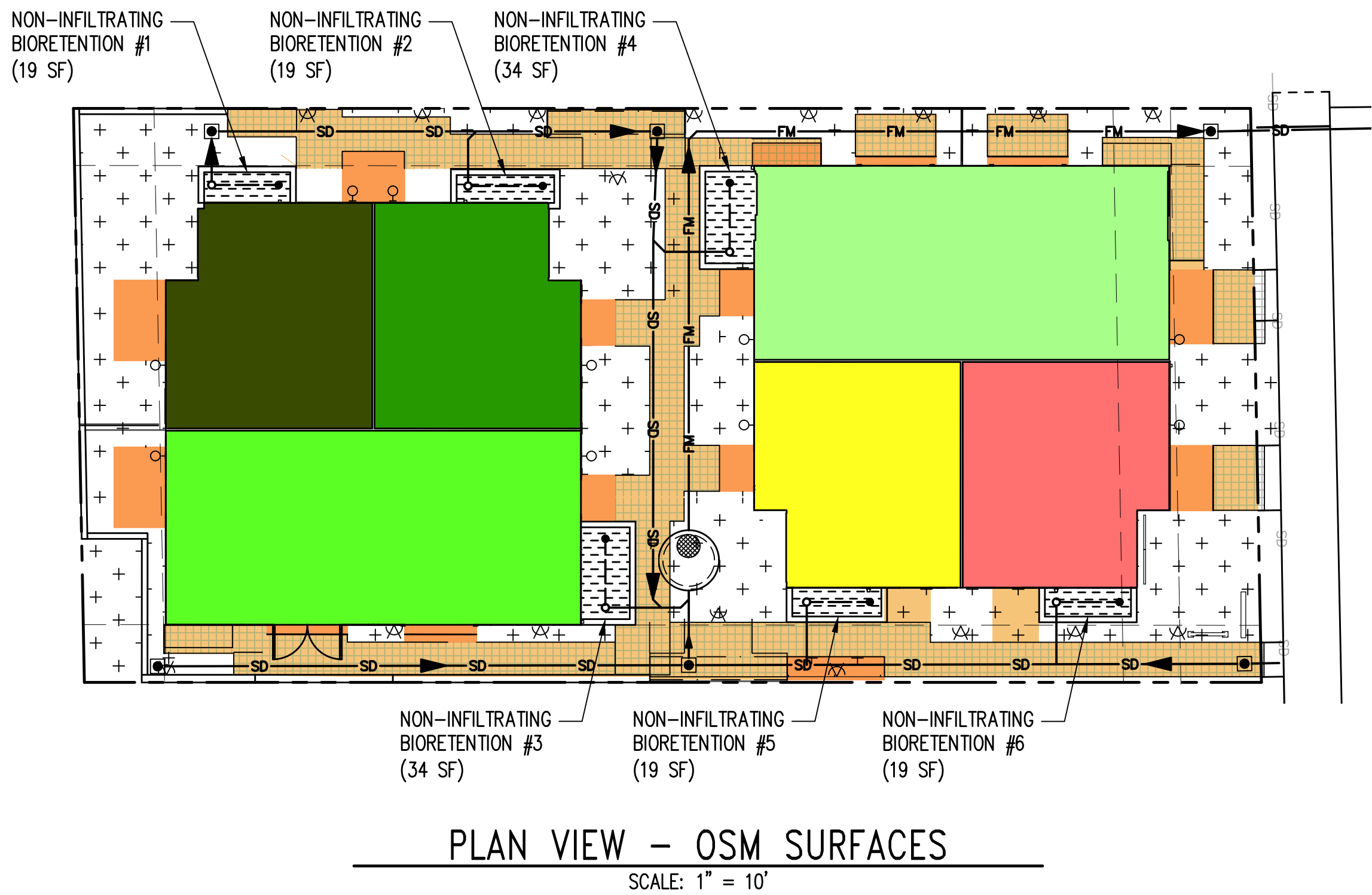

SURFACE AREA LEGEND: (PER OSM CALCULATOR)		MITIGATED SURFACE (SF)
	SURFACE 1: ROOF TO NON-INFILTRATING BIORETENTION PLANTER #1	336
	SURFACE 2: ROOF TO NON-INFILTRATING BIORETENTION PLANTER #2	336
	SURFACE 3: ROOF TO NON-INFILTRATING BIORETENTION PLANTER #3	611
	SURFACE 4: ROOF TO NON-INFILTRATING BIORETENTION PLANTER #4	611
	SURFACE 5: ROOF TO NON-INFILTRATING BIORETENTION PLANTER #5	336
	SURFACE 6: ROOF TO NON-INFILTRATING BIORETENTION PLANTER #6	336
	SURFACE 7: PERMEABLE PAVEMENT SURFACE	888
	SURFACE 8: UNMITIGATED HARD SURFACE	214
	LAWN AND LANDSCAPING	1,458
	NON-INFILTRATING BIORETENTION PLANTER	

BIORETENTION PLANTER (NON-INFILTRATING)

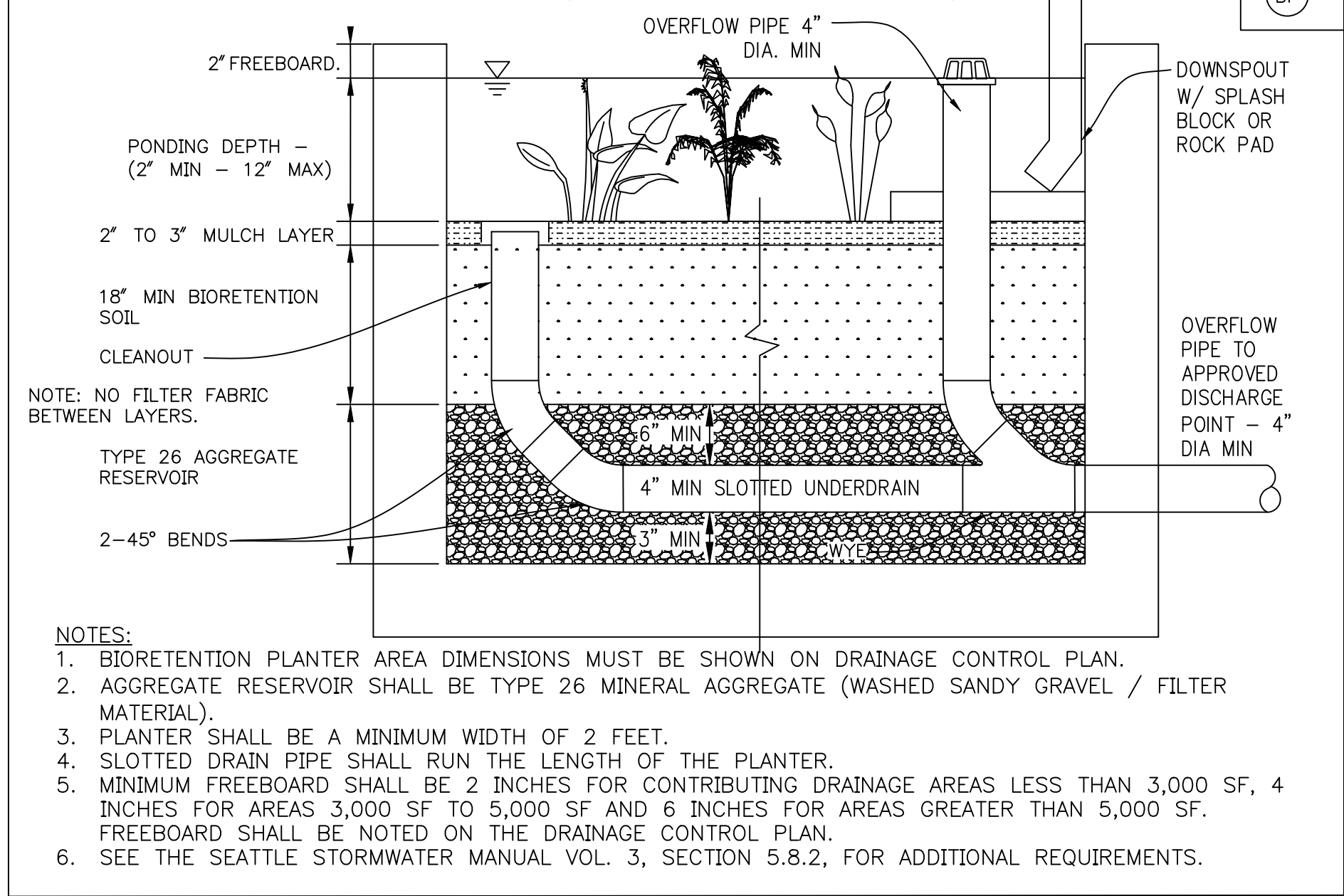

TYPICAL COS NON-INFILTRATING BIORETENTION PLANTER

N.T.S.

1
C4.00

NOTES:

- NON-INFILTRATING BIORETENTION PLANTERS SHALL BE CONSTRUCTED TO MEET THE FOLLOWING MINIMUM REQUIREMENTS:
 - THE MINIMUM FREEBOARD SHALL BE 2 INCHES FOR CONTRIBUTING DRAINAGE AREAS LESS THAN 3,000 SF, 4 INCHES FOR DRAINAGE AREAS 3,000 SF TO 5,000 SF AND 6 INCHES FOR DRAINAGE AREAS GREATER THAN 5,000 SF.
 - THE OVERFLOW PIPE SHALL BE 4 INCHES MINIMUM DIAMETER.
 - THE PONDING DEPTH SHALL BE 2 INCHES MINIMUM AND 12 INCHES MAXIMUM BETWEEN THE TOP OF THE MULCH LAYER AND THE OVERFLOW PIPE RIM.
 - THE MINIMUM DEPTHS OF MATERIAL IN THE PLANTER SHALL BE: A 2 INCH MULCH LAYER OVER 18 INCHES OF BIORETENTION SOIL OVER 13 INCHES OF TYPE 26 AGGREGATE RESERVOIR.
 - NO FILTER FABRIC SHALL BE PROVIDED BETWEEN DIFFERENT MATERIAL LAYERS.
 - THE SLOTTED UNDERDRAIN PIPE SHALL RUN THE LENGTH OF THE PLANTER AND TERMINATE WITH TWO 45 DEGREE BENDS AND A CLEANOUT.
 - THE PLANTER WIDTH SHALL HAVE A MINIMUM INSIDE WIDTH OF 2 FEET.
 - A SPLASH BLOCK OR ROCK PAD SHALL BE PROVIDED AT DOWNSPOUT DISCHARGE POINTS.
 - ALL ADDITIONAL REQUIREMENTS FOUND IN THE SEATTLE STORMWATER MANUAL VOLUME 3, SECTION 5.8.2.

On-site Stormwater Management - List Approach Calculator Site and Drainage Control Summary			
Version 07-28-2017			
To use the On-Site List Calculator you must select "Enable Content" when the Security Warning appears.			
Project Information			
Site Address	8839 Midvale Avenue N	SDCI Project Number	6628930
Primary Contact	Sky McClave	SDOT Project Number	
Project Type	Parcel-Based	Primary Contact E-mail or Phone	Sky.McClave@kpff.com
Total Site Area	5,126 sf		
Total New plus Replaced Hard Surface Area	3,668 sf		
Existing Hard Surface Area to Remain	0 sf		
Total New and/or Replaced Lawn and Landscaping	1,458 sf		
Undisturbed and protected site area	0 sf		
Was the project lot created or reduced in size after Jan 1, 2016?	Yes		
Project Engineer	Sky McClave	Engineer E-mail	Sky.McClave@kpff.com
On-site Stormwater Management is required for ≥ 750 sf of new plus replaced area.			
On-site Performance Standard will be used (professional engineer required)?			
No			
Site Information			
Note: If required for your project, reference the Preliminary Assessment Report (PAR) to complete this section. If the total areas proposed are different from those provided in the PAR, requirements may change.			
Approved Point of Stormwater Discharge	Curb Weep Hole		
Drainage Basin	Small Lake Basins		
Is the downstream drainage system considered Capacity Constrained by SPU?	Yes		
Approved Point of Wastewater Discharge	Public Sanitary Sewer Main		
Approved Point of Sub-Surface Discharge	On Site Infiltration		
Flow Control is required	Yes		
Flow Control Standard	Peak Control Standard		
Water Treatment for pollution-generating surfaces is required	No		
Select required treatment	<input type="checkbox"/> Oil Control	<input type="checkbox"/> Phosphorus	<input type="checkbox"/> Enhanced
Total Pollution Generating Hard Surface Area	sf		
Total Pollution Generating Pervious Surface Area	sf		
Source Control is required	No		
Environmentally Critical Areas	No		
<input type="checkbox"/> Steep Slope	<input type="checkbox"/> Potential Slide	<input type="checkbox"/> Riparian Corridor	<input type="checkbox"/> Wetland
<input type="checkbox"/> Landfill	<input type="checkbox"/> Known Landslide	<input type="checkbox"/> Fish / Wildlife	<input type="checkbox"/> Peat / Groundwater Management
Temporary dewatering required	No		
Is there known soil and/or groundwater contamination on this site?	No		
A licensed professional recommends dispersion not be used anywhere within the project site due to reasonable concerns of erosion, slope failure, or flooding.	No		
Infiltration Information			
Is infiltration investigation required?	Yes	Type of test:	Simple infiltration test
Is infiltration on the site feasible?	Yes	Infeasibility criteria for "All Infiltration BMPs" applies	
Site Measured Infiltration Rate	0.43	x Infiltration Rate Correction Factor	0.5 = 0.215
Site Design Inf Rate			
On-site Stormwater Management			
Number of roof areas	6		
Number of other surface areas	2		
Surface	Surfaces Description	On-site BMP	Contrib. Area (sf)
1	Roof/Roof Surface #1	Non-Infiltrating Bioretention #1	336
2	Roof/Roof Surface #2	Non-Infiltrating Bioretention #2	336
3	Roof/Roof Surface #3	Non-Infiltrating Bioretention #3	611
4	Roof/Roof Surface #4	Non-Infiltrating Bioretention #4	611
5	Roof/Roof Surface #5	Non-Infiltrating Bioretention #5	336
6	Roof/Roof Surface #6	Non-Infiltrating Bioretention #6	336
7	Surface:Pavement - Surf	Permeable Pavement Surface	888
8	Surface:Unmitigated Har	None Feasible	214
Total New/Replaced Roof Area	2,566		Total Roof Area Managed
Total New/Replaced Other Surface Area	1,102		Total Other Surface Managed
Total Area Managed	3,668		Total Volume Managed On Site
Estimated compost required for soil amendment	9.0396 cy		Volume of compost required for soil amendment will be verified by the DPD Site Inspector for SDCI permitted projects.

CARON

2505 3RD AVE #300C
SEATTLE WA 98121

T 206.367.1382 F 206.367.1385
W CARONARCHITECTURE.COM

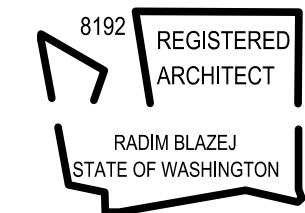

kpff

1601 5th Avenue, Suite 1600
Seattle, WA 98101
206.622.5822
www.kpff.com

MIDVALE TOWNHOUSES

8839 MIDVALE AVE N
SEATTLE, WA 98103

SDCI # 6628930-CN

BUILDING PERMIT SUBMITTAL

DISCLAIMER
THIS SET OF DRAWINGS AND DOCUMENTS IS FOR BUILDING PERMIT SUBMITTAL ONLY AND DOES NOT CONSTITUTE A COMPLETE SET OF DOCUMENTS FOR ANY OTHER PURPOSE.

SUBMITTAL / REVISION	DATE
BUILDING PERMIT SUBMITTAL	05.17.2018
BUILDING PERMIT RE-SUBMITTAL	01.07.2019



ON-SITE STORMWATER MANAGEMENT PLAN

SHEET NUMBER

C5.00

CARON PROJECT NO. 17_085

Z:\1700001-1700999\1700999_8839 Midvale Ave\CADD\Design\OnSite\WP-C5-00-01.dwg

Ad6/6/T

Jan 07, 2019 - 3:20pm

